

INVESTIGATE INNOVATE IMPACT

UC IRVINE | SCHOOL of SOCIAL SCIENCES

*where I make a difference*



[www.socsci.uci.edu](http://www.socsci.uci.edu)

**2012-2013**

**Freshmen Student Handbook**

UNIVERSITY of CALIFORNIA



IRVINE



SCHOOL *of* SOCIAL SCIENCES

---

UNIVERSITY *of* CALIFORNIA • IRVINE



SCHOOL OF SOCIAL SCIENCES UNDERGRADUATE STUDENT AFFAIRS

1201 Social & Behavioral Sciences Gateway  
Irvine, CA 92697-5100  
(949) 824-6803 Phone  
(949) 824-2492 Fax  
[http://undergraduatestudies.ss.uci.edu/ugs\\_usa](http://undergraduatestudies.ss.uci.edu/ugs_usa)

May 11, 2012

Dear New Social Sciences Student,

On behalf of the faculty and staff in the School of Social Sciences, I would like to congratulate you on your acceptance to UCI and the School of Social Sciences. An important component of your academic success is the careful selection of courses appropriate to your educational goals. To ensure that you enroll in the appropriate courses, complete the following steps:

1. **READ the New Student Checklist:** <http://www.newstudents.uci.edu/>
2. **READ the Anteater Zot Start website:** <http://www.students.uci.edu/anteaterzotstart>  
This is a pre-advising program that must be completed **BEFORE** you can register for a summer orientation program (SPOP). This website will provide you with links and information about placement testing, general education requirements, majors, schedule of classes, registration, etc.
3. **REGISTER FOR A SPOP:** <http://www.students.uci.edu/welcome>  
All new students are required to attend a Summer Orientation Program (SPOP). Please go to the UCI Dean of Students site for orientation information and how to register.
4. **BEFORE ORIENTATION:**
  - Complete the **Statement of Legal Residence:** <http://www2.reg.uci.edu/slr/>
  - Ensure that all official transcripts and any exam scores such as, AP, IB, SAT have been received by the UCI Office of Admissions.
  - Make copies of official exam scores and any college transcripts if applicable and bring them to orientation. Proof of scores may be required for enrollment in certain courses.
  - **REVIEW:** UCI General Catalogue. UCI uses an electronic catalogue that can be found at <http://www.editor.uci.edu/catalogue/>.  
Note: The 2012-2013 catalogue will be ready in mid June.
  - If you plan to bring your own laptop to orientation, you must register it prior to your SPOP date in order to use UCI's mobile internet access across the campus. **UCinet Mobile Access** provides a fast and convenient way to connect to the web with mobile computers and devices. To register a laptop, follow these instructions:

- 1) Student must have a UCI Net ID and password.
- 2) Go to <http://www.nacs.uci.edu/ucinet/mobile/>
- 3) Click on the link "Register"
- 4) Follow the instructions for Manual Registration. Additional information is available to help students find their MAC address (PC or Mac laptop ID needed for registration with UCI).
- 5) Account will be activated 5 minutes after student completes process.

*NOTE: It is not necessary to bring a laptop since course registration is conducted in a computer lab.*

5. **ENROLL in SOCIAL SCIENCE 89-FRESHMEN SUMMER SEMINAR (SUMMER SESSION 2):** Though not a requirement, we strongly recommend this course a sound preparation for the start of your collegiate experience. This 2-unit course introduces students to a variety of academic resources and campus opportunities, the basics of conducting research in the Social Sciences, test-and note-taking skills, and networks of faculty and community leaders.
6. **PAY FEES:** Student billing must be accessed via the e-billing system at <https://zotaccount.uci.edu/>. Fees must be received by the Cashier's Office by September 17<sup>th</sup> at 4:00pm (if paying in person) or 5:00pm (via online payment) to maintain your enrollment. If the payment is late, you will be dropped from all your classes.
7. **DOUBLE CHECK:** Access WebReg after noon on September 20<sup>th</sup> to verify course enrollments, times, and locations.
8. **WELCOME WEEK:** September 24<sup>th</sup> through September 26<sup>th</sup> is "UCI's Welcome Week". Below are some important events:
  - **Monday, Sept. 24<sup>th</sup> at 10:30AM Social Sciences Dean's Welcome**
  - Get your UCI Student ID card from UCItems located in the UCI Student Center.
  - Buy your course books at the UCI Bookstore.
  - Instruction begins on **Thursday, September 27<sup>th</sup>**.
9. **FACEBOOK:** Become a Fan of the School of Social Sciences by going to: <http://www.facebook.com/ucisocialsciences>



If you have questions about any of the above information, please visit the Social Sciences Undergraduate Student Affairs website at [http://undergraduestudies.ss.uci.edu/ugs\\_usa](http://undergraduestudies.ss.uci.edu/ugs_usa) for more up-to-date information or contact a Social Sciences academic advisor at (949) 824-6803 or by email at [socsci@uci.edu](mailto:socsci@uci.edu). We look forward to seeing you this summer and wish you success in your academic career at UCI!

Sincerely,

A handwritten signature in black ink that reads "Mark P. Petracca".

Mark P. Petracca  
Associate Dean for Undergraduate Studies

**TABLE OF CONTENTS**

Social Sciences Undergraduate  
Student Affairs (SSUSA)..... 7

Course Planning Sheets for Social Sciences  
Major with writing component..... 8

Course Planning Sheets for Social Sciences  
Major without writing component..... 11

**GETTING STARTED**

What is a UCI NetID?..... 14

Webmail (UCI Email)..... 14

Email Etiquette ..... 14

Schedule of Classes (WebSOC)..... 15

Key Terms..... 15

Class Registration (WebReg)..... 16

Video Tutorial ..... 16

Enrollment Menu..... 17

Waiting List Menu ..... 18

Student Billing System..... 19

Billing Statement ..... 20

PACE Payment Plan (Installment Payments) .. 21

For New Students..... 21

For Students with Financial Aid..... 21

Health Insurance ..... 22

Student Access ..... 22

**SOCIAL SCIENCE REQUIREMENTS**

University Requirements ..... 23

School of Social Sciences Requirements..... 23

General Education Requirements ..... 24

Incomplete Humanities Core Series.....25

What can I do with a Social  
Sciences major? ..... 29

Strategies ..... 29

Change of Major Requirements ..... 30

Minors ..... 31

Certificates ..... 32

Transfer Units..... 32

ASSIST ..... 33

College Board Advanced Placement ..... 34

International Baccalaureate Exams ..... 36

**SCHOOL OF SOCIAL SCIENCES POLICIES**

Student Affairs Office Functions ..... 38

Study Abroad Advising ..... 38

Academic Probation/Contract..... 38

Dean’s Signature ..... 39

Cancellation/Withdrawal..... 39

Readmission..... 39

---

Poor Academic Standing.....	39
Part-Time Student Status .....	39
How Long Do I Have To Add/Drop/Change Classes? .....	39
When Can I Retake A Class? How Many Can I Retake? .....	40
Transcript Notations .....	40
Petitions.....	40
Prerequisite Clearance.....	40

## **STUDENT RESOURCES**

Student Resources List.....	41
-----------------------------	----



## **SCHOOL OF SOCIAL SCIENCES MAJORS & MINORS**

*Majors with an asterisk (\*) also offer a minor*

- Anthropology\*
- Chicano/Latino Studies\*
- Business Economics
- Economics\*
- Quantitative Economics
- International Studies\*
- Political Science\*
- Psychology\*
- Social Policy & Public Service
- Sociology\*



### **OFFICE INFORMATION**

Monday – Friday

8:00A.M. – 12:00P.M. & 1:00 – 5:00P.M.

Social & Behavioral Sciences, Suite 1201

Irvine, CA 92697-5100

**Phone:** (949) 824-6803

**Fax:** (949) 824-2492

**E-mail:** [socsci@uci.edu](mailto:socsci@uci.edu)

[http://undergraduatestudies.ss.uci.edu/ugs\\_usa](http://undergraduatestudies.ss.uci.edu/ugs_usa)

### **ACADEMIC COUNSELORS**

- Helen Morgan, Director
- Chika Kono, Associate Director
- Kurt Hessinger
- Estela Magaña
- Ramón Muñoz

### **PEER ACADEMIC ADVISORS**

- Kristen Ahn (Psychology)
- Karen Chan (Business Economics)
- Stephanie Chukwu (Political Science)
- Kathy Dong (Political Science & Sociology)
- Fareshte Erani (Psychology)
- Mehwish Shakeel (International Studies)
- Billy Sun (Sociology)
- Jazmine Wong (Anthropology)
- Jenny Yun (Business Economics)

If you have a smart phone, scan this QR code to visit: *the School of Social Sciences Undergraduate Student Affairs Office*



## Course Planning Sheets for Social Sciences Majors

with Writing Component

### FRESHMAN, ACADEMIC YEAR 2012-2013

All freshmen should take Social Sciences 3A (Computer Based Research in the Social Sciences) during their first year, regardless of major.

The School of Social Sciences' mathematics requirement should be completed during the second year (Anthropology 10A-B-C or Economics 15A-B or Psychology 10A-B-C or Sociology 10A-B-C or Social Science 10A-B-C), and they must be taken for a grade.

We strongly encourage students to finish the foreign language requirement as soon as possible if you still

need to take more classes (you must take the placement exam for all languages-except French and German).

UC Entry Level Writing requirement must be satisfied before the beginning of your fourth quarter of enrollment.

Any course used to satisfy the UC Entry Level Writing requirement must be taken for a grade.

Lower-division writing must be completed before the beginning of your seventh quarter of enrollment.

### SAMPLE COURSE SCHEDULES BY MAJOR 2012-2013

Social Science 3A should be taken during your first year. \*First-Year Integrated Program (FIP): Uni Stu 13 A-B-C or Uni Stu 15 A-B-C or Unit Stu 16 A-B-C or Uni Stu 17 A-B-C may be taken instead of Humanities Core 1 A-B-C.

#### ANTHROPOLOGY

FALL 2012: 12-14 units	WINTER 2013: 16 units	SPRING 2013: 16 units
*Hum Core 1A or 1A S/A = 8-10 units	*Hum Core 1B	*Hum Core 1C
Anthropology 2A = 4 units	Anthropology 2B, 2C, or 2D	Soc Sci Introductory Course
	Anth 30A/30B or General Ed (GE) or Soc Sci 3A	Anth 30A/30B or General Ed or Soc Sci 3A

-OR-

Writing 39A or 37 = 4-6 units	Writing 39B	Writing 39C
Anthropology 2A = 4 units	Anthropology 2B, 2C, or 2D	Soc Sci Introductory Course
General Education or Elective = 4 units	Anth 30A/30B or General Ed (GE) or Soc Sci 3A	Anth 30A/30B or General Ed or Soc Sci 3A
	General Education or Elective	General Education or Elective

#### CHICANO/LATINO STUDIES

FALL 2012: 12-14 units	WINTER 2013: 16 units	SPRING 2013: 16 units
*Hum Core 1A or 1A S/A = 8-10 units	*Hum Core 1B	*Hum Core 1C
Chc/Lat Studies 61 = 4 units	Chc/Lat Studies 62	Chc/Lat Studies 63
	General Education or Soc Sci 3A	General Education or Soc Sci 3A

-OR-

Writing 39A or 37 = 4-6 units	Writing 39B	Writing 39C
Chc/Lat Studies 61 = 4 units	Chc/Lat Studies 62	Chc/Lat Studies 63
General Education or Elective = 4 units	General Education or Soc Sci 3A	General Education or Soc Sci 3A
	General Education or Elective	General Education or Elective



**ECONOMICS<sup>1</sup>**

FALL 2012: 12-14 units	WINTER 2013: 16 units	SPRING 2013: 16 units
*Hum Core 1A or 1A S/A = 8-10 units	*Hum Core 1B	*Hum Core 1C
Math 2A	Math 2B	Math 4
	Econ 20A	Econ 20B

**-OR-**

Writing 39A or 37 = 4-6 units	Writing 39B	Writing 39C
Econ 20A = 4 units	Econ 20B	Math 4
Math 2A = 4 Units	Math 2B	Lower-Division Econ
	Soc Sci 3A or Soc Sci Intro Course or General Education	Soc Sci 3A or Soc Sci Intro Course or General Education

**INTERNATIONAL STUDIES<sup>2</sup>**

FALL 2012: 12-14 units	WINTER 2013: 16 units	SPRING 2013: 16 units
*Hum Core 1A or 1A S/A = 8-10 units	*Hum Core 1B	*Hum Core 1C
Int'l Studies 11 = 4 units	International Studies 14	Int'l Studies 13
	Soc Sci 3A or Language or General Ed	Soc Sci 3A or Language or General Education

**- OR -**

Writing 39A or 37 = 4-6 units	Writing 39B	Writing 39C
Int'l Studies 11 = 4 units	International Studies 14	Int'l Studies 13
General Ed or Elective or Language = 4-5 units	Soc Sci 3A or General Education	Soc Sci 3A or General Education
	General Education or Elective or Language	General Education or Elective or Language

**POLITICAL SCIENCE**

FALL 2012: 12-14 units	WINTER 2013: 16 units	SPRING 2013: 16 units
*Hum Core 1A or 1A S/A = 8-10 units	*Hum Core 1B	*Hum Core 1C
Lower-Division Political Science = 4 units	Lower-Division Political Science	Lower-Division Political Science
	General Education or Soc Sci 3A	General Education or Soc Sci 3A

**- OR -**

Writing 39A or 37 = 4-6 units	Writing 39B	Writing 39C
Lower-Division Political Science = 4 units	Lower-Division Political Science	Lower-Division Political Science
General Education or Elective = 4 units	General Education or Soc Sci 3A	General Education or Soc Sci 3A
	Elective or General Education	Elective or General Education

1. Economics majors must not enroll in Economics 1 (for non-majors), you will NOT receive credit.
2. International Studies majors are especially encouraged to start the foreign language requirement as soon as possible. All languages (except French and German) require a placement exam.

## Course Planning Sheets for Social Sciences Majors

with Writing Component

### PSYCHOLOGY (COGNITIVE SCIENCES)<sup>3,4</sup>

FALL 2012: 12-14 units	WINTER 2013: 16 units	SPRING 2013: 16 units
*Hum Core 1A or 1A S/A = 8-10 units	*Hum Core 1B	*Hum Core 1C
Psych 9A = 4 units	Psych 9B	Psych 9C
	Soc Sci Intro or General Ed or Computer Tech	Soc Sci Intro or General Ed or Computer Tech

- OR -

Writing 39A or 37 = 4-6 units	Writing 39B	Writing 39C
Psych 9A = 4 units	Psych 9B	Psych 9C
General Ed or Soc Sci Intro Course = 4 units	Soc Sci Intro Course	Soc Sci Intro Course or Breath
	* Computer Tech or General ED	* Computer Tech or General ED

### SOCIOLOGY

FALL 2012: 12-14 units	WINTER 2013: 16 units	SPRING 2013: 16 units
*Hum Core 1A or 1A S/A = 8-10 units	*Hum Core 1B	*Hum Core 1C
Sociology 1 = 4 units	Sociology 2 or 3	Soc Sci Intro Course
	General Ed or Soc Sci 3A	General Ed or Soc Sci 3A

- OR -

Writing 39A or 37 = 4-6 units	Writing 39B	Writing 39C
Sociology 1 = 4 units	Sociology 2 or 3	Soc Sci Intro Course
General Ed or Soc Sci Intro Course = 4 units	General Ed or Soc Sci 3A	General Ed or Soc Sci 3A
	Elective or Introductory Course	Elective

3. Psychology majors must not enroll in Psychology 7A (for non-majors), you will NOT receive credit.
4. Psychology majors are encouraged to take either ICS 31 or Psych 114M to satisfy the Computer Technology Requirement.

**FRESHMAN, ACADEMIC YEAR 2012-2013**

All freshmen should take Social Sciences 3A (Computer Based Research in the Social Sciences) during their first year, regardless of major.

The School of Social Sciences' mathematics requirement should be completed during the second year (Anthropology 10A-B-C or Economics 15A-B or Sociology 10A-B-C or Social Science 10A-B-C), and they **MUST BE TAKEN FOR A GRADE**.

We strongly encourage students to finish the foreign language requirement as soon as possible if you still need to take more classes (you must take the placement exam for all languages-except French and German).

UC Entry-Level Writing requirement must be satisfied before the beginning of your fourth quarter of enrollment.

Any course used to satisfy the UC Entry Level Writing requirement must be taken for a grade.

Lower-division writing must be completed before the beginning of your seventh quarter of enrollment.

**SAMPLE COURSE SCHEDULES BY MAJOR 2012-2013**

Social Science 3A should be taken during your first year. \*First-Year Integrated Program (FIP): Uni Stu 13 A-B-C or Uni Stu 15 A-B-C or Unit Stu 16 A-B-C or Uni Stu 17 A-B-C may be taken instead of Humanities Core 1 A-B-C.

**ANTHROPOLOGY**

FALL 2012: 12 units	WINTER 2013: 16 units	SPRING 2013: 16 units
General Ed (Cat II, IV, VII) = 4 units	Writing 39A or 39B	Writing 39B or 39C
Anthropology 2A = 4 units	Anthropology 2B, 2C, or 2D	Soc Sci Introductory Course
General Education or Elective	Anth 30A/30B or General Ed or Soc Sci	Anth 30A/30B or General Ed or Soc Sci
	General Education or Elective	General Education or Elective

**CHICANO/LATINO STUDIES**

FALL 2012: 12 units	WINTER 2013: 16 units	SPRING 2013: 16 units
General Ed (Cat II, IV, VII) = 4 units	Writing 39A or 39B	Writing 39B or 39C
Chc/Lat Studies 61 = 4 units	Chc/Lat Studies 62	Chc/Lat Studies 63
General Education or Elective = 4 units	General Education or Soc Sci 3A	General Education or Soc Sci 3A
	General Education or Elective	General Education or Elective

**ECONOMICS<sup>1</sup>**

FALL 2012: 12 units	WINTER 2013: 16 units	SPRING 2013: 16 units
General Ed (Cat II, IV, VII) = 4 units	Writing 39A or 39B	Writing 39B or 39C
Econ 20A = 4 units	Econ 20B	Math 4
Math 2A = 4 Units	Math 2B	Lower-Division Econ
	Soc Sci 3A or Soc Sci Intro Course or General Education	Soc Sci 3A or Soc Sci Intro Course or General Education

**INTERNATIONAL STUDIES<sup>2</sup>**

FALL 2012: 12-13 units	WINTER 2013: 16 units	SPRING 2013: 16 units
General Ed (Cat II, IV, VII) = 4 units	Writing 39A or 39B	Writing 39B or 39C
Int'l Studies 11 = 4 units	International Studies 14	Int'l Studies 13
General Ed or Elective or Language = 4-5 units	Soc Sci 3A or General Education	Soc Sci 3A or General Education
	General Ed or Elective or Language	General Ed or Elective or Language

**POLITICAL SCIENCE**

FALL 2012: 12 units	WINTER 2013: 16 units	SPRING 2013: 16 units
General Ed (Cat II, IV, VII) = 4 units	Writing 39A or 39B	Writing 39B or 39C
Lower-Division Political Science = 4 units	Lower-Division Political Science	Lower-Division Political Science
General Education or Elective = 4 units	General Education or Soc Sci 3A	General Education or Soc Sci 3A
	Elective or General Education	Elective or General Education

**PSYCHOLOGY (COGNITIVE SCIENCES)<sup>3,4</sup>**

FALL 2012: 12 units	WINTER 2013: 16 units	SPRING 2013: 16 units
General Ed (Cat II, IV, VII) = 4 units	Writing 39A or 39B	Writing 39B or 39C
Psych 9A = 4 units	Psych 9B	Psych 9C
General Ed or Soc Sci Intro Course = 4 units	Soc Sci Intro Course	Soc Sci Intro Course or General Ed
	* Computer Tech or General ED	* Computer Tech or General ED

**SOCIOLOGY**

FALL 2012: 12 units	WINTER 2013: 16 units	SPRING 2013: 16 units
General Ed (Cat II, IV, VII) = 4 units	Writing 39A or 39B	Writing 39B or 39C
Sociology 1 = 4 units	Sociology 2 or 3	Soc Sci Intro Course
General Ed or Soc Sci Intro Course = 4 units	General Ed or Soc Sci 3A	General Ed or Soc Sci 3A
	Elective or Introductory Course	Elective

- 1 Economics majors must not enroll in Economics 1 (for-non majors), you will **NOT** receive credit.
- 2 International Studies majors are encouraged to take language (up to 2C or equivalent) as soon as possible. All languages (except French and German) require a placement exam.
- 3 Psychology majors must not enroll in Psychology 7A (for non-majors), you will NOT receive credit.
- 4 Psychology department RECOMMENDS students take ICS 31 or approved Psych computer Course (PSYCH 114M) to satisfy the computer technology requirement.

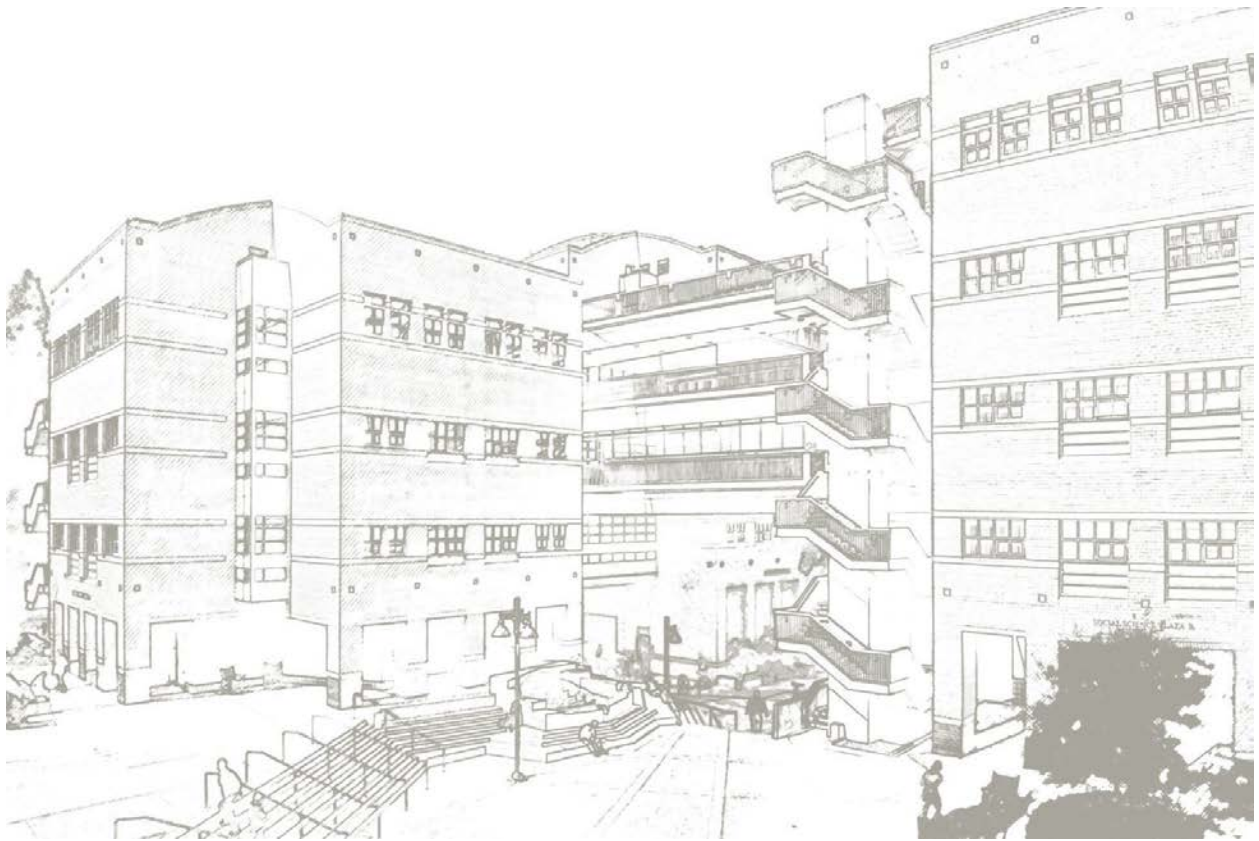

## Getting Started

### Important information

#### WHAT IS A UCInetID?

Your UCInetID is your key to online services at the University of California, Irvine. Many online services, including Webmail, WebReg, EEE, and numerous others, require you to use your UCInetID and password in order to log in.

Your UCInetID is for your individual use only. Do not share your password with anyone.

Activate your UCInetID:

<http://activate.uci.edu/activate/menu.html>

- You will need your Student ID number (8 digits), date of birth, and the last 4 digits of your Social Security number.

#### WEBMAIL (E-mail)

To access your UCI email account, you must first activate your UCInetID. Note that all official notices and emails will be sent to this email address.

- Go to <http://webmail.uci.edu>.
- Login with your UCInetID and password.

#### E-mail ETIQUETTE

Here are some tips on how to use email most effectively to communicate with academic counselors (and other UCI personnel).

1. Use your UCI email address (for UCI correspondence). To protect your privacy, many UCI offices will only respond to messages from UCI e-mail accounts.
2. Identify yourself. When you send an email to an academic counselor, be sure to include your FULL- NAME, your MAJOR, and your UCI ID NUMBER. We need to know who we are talking to in order to give you accurate information.
3. Be considerate. Do not send the same question to more than one person in an office. There's no reason for three or four different people to answer the same question!
4. Check your email regularly. Lots of important information (some of it essential to your success as a student) will be sent by professors, academic counselors, and other UCI personnel. YOU are responsible for reading all official UCI emails sent to your account, and YOU will suffer the consequences if you miss important messages.
5. Be clear and concise. Try to keep email messages brief.
6. Be flexible. Some advising issues really need to be handled in person. Do not be offended if we ask you to make an appointment to discuss your questions—we do this to avoid wasting your time and ours with back-and-forth questions and answers that could be handled more quickly in person.
7. Delete unwanted/old messages. If you do not read your UCI email regularly and clear out old messages and spam, your inbox will fill up and important email messages may be returned and undelivered.
8. Be professional. Treat emails as a formal communication—do not use text messaging abbreviations, slang, four-letter words, etc. if you want to be taken seriously. Watch your grammar, spelling, etc.
9. Be nice. Keep the tone of your email civil. It is very easy for us (and your professors) to forward email and to print it off and put it in your file—it is not anonymous. DO NOT WRITE YOUR EMAIL MESSAGES IN ALL CAPITAL LETTERS. This is incredibly annoying and is often perceived as being hostile or confrontational.
10. Be patient. Sometimes you may get a response immediately, while at other times it may take a few days since we are often very busy. If you are really in a hurry to get an answer, drop by or call the office.

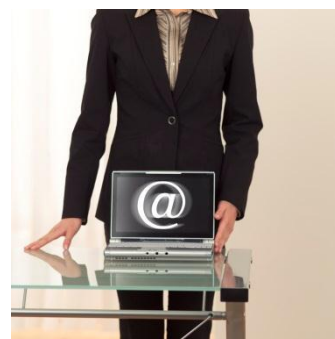

**SCHEDULE OF CLASSES (WebSOC)**

- Schedule of Classes is accessible from <http://www.reg.uci.edu>. Available online in Week 6 for the upcoming academic quarter.

• To find:

- ✓ Major courses: Select appropriate department, then click “Display Web Results”
- ✓ General Education courses: Select GE category, then click “Display Web Results”

- When selecting courses, pay attention to times, dates, and places. Also write down the 5 digit code which you will need to register through WebReg.

When there are different types of courses listed under the “Typ” column, you must enroll in one of each type to maintain your enrollment in the course. Note if there is more than one lecture offered, you must select the corresponding co-class to enroll (See picture below).

Soc Sci 3A COMP RES IN SOC SCI														
Code	Type	Sec	Units	Instructor	Time	Place	Final	Max	Enr	Req	Rstr	Textbooks	Web	Status
70030	Lec	A	4	CHRISTOPHERSON, J.	TuTh 2:00-3:20p	SSLH 100	Thu, Mar 17, 1:30-3:30pm	387	383	526		Bookstore	Web	OPEN
70031	Lab	A1	0	MILLS, S. CHRISTOPHERSON, J.	TuTh 3:30-4:50p	MSTB 226								
70032	Lab	A2	0	MILLS, S. CHRISTOPHERSON, J.	TuTh 5:00-6:20p	MSTB 226								
70033	Lab	A3	0	TABARES, J. CHRISTOPHERSON, J.	TuTh 9:30-10:50	MSTB 226								
70034	Lab	A4	0	MORGAN, P. CHRISTOPHERSON, J.	TuTh 11:00-12:20p	MSTB 226								
70035	Lab	A5	0	GLADIEUX, J. CHRISTOPHERSON, J.	WF 11:00-12:20p	SST 155								
70036	Lab	A6	0	MOTES, A. CHRISTOPHERSON, J.	WF 12:30-1:50p	SST 155								
70037	Lab	A7	0	MOTES, A. CHRISTOPHERSON, J.	WF 2:00-3:20p	SST 155		44	44	52	B	Bookstore		FULL
70038	Lab	A8	0	TABARES, J. CHRISTOPHERSON, J.	TuTh 8:00-9:20	MSTB 226		43	42	55	B	Bookstore		OPEN
70039	Lab	A9	0	GLADIEUX, J. CHRISTOPHERSON, J.	WF 8:00-9:20	MSTB 226		26	26	27	B	Bookstore		FULL
70050	Lec	B	4	SHIREY, P.	MWF 1:00-1:50p	SSLH 100	Wed, Mar 16, 1:30-3:30pm	350	274	329		Bookstore	Web	OPEN
70051	Lab	B1	0	MONTOYA, O. SHIREY, P.	WF 2:00-3:20p	MSTB 210		46	45	51		Bookstore	Web	OPEN
70052	Lab	B2	0	SAGI, R. SHIREY, P.	WF 3:30-4:50p	SST 155		48	47	56		Bookstore	Web	OPEN

**NOTE:** Section A(Code 70030) lecture and section A1-A9 (Codes 70031-70039) labs. An attempt to enroll in lecture 70030 (Section A) and lab 70052 (Section B2) will result in the message “**CO CLASS MISMATCH**”. You will be dropped from the class once you log out of WebReg, if fail to correct the enrollment error.

**KEY TERMS**

- ✓ Open: Class is open to all students who meet the prerequisites (if any)
- ✓ Waitlist: The maximum class enrollment has been reached but students may waitlist the course so that if any currently enrolled student drops the course, the waitlisted students will be automatically enrolled.
- ✓ Full: Enrollment and waitlist positions are full. Student cannot electronically enroll in the course.
- ✓ EAD: Indicates courses as “electronic add/drop”.
  - Column Definitions, Building Abbreviations, Restriction Codes, and Campus Map are conveniently located at the bottom of each WebSOC results page.

## Getting Started

Important information

### CLASS REGISTRATION (WebReg)

WebReg is accessible from <http://www.reg.uci.edu>. UCInetID and password required. Use WebReg to enroll in classes and make schedule changes during the registration period and the adjustment period. WebReg is available from 6:00 AM to 4:00 AM, daily, with occasional down times for special circumstances such as final grade update.

After logging in with UCInetID and password, you should see this Menu.



**Video Tutorial:** <http://www.youtube.com/watch?v=lzOLwzxCxG0&feature=youtu.be>



### FALL Quarter Menu

Logout

[Enrollment Changes Beginning Fall 2010](#)

Enrollment Menu	Add, drop, or change your course enrollment.
Wait list Menu	Add or drop courses on the Wait List.

### Enrollment Information

Enrollment Window	Display the date and time you can first enroll through WebReg.
Fee Status	Display whether your fees have been received.
Study List	Display your class schedule.

**your enrollment window opens on MAY 18, '10 at 08:30am**

### ENROLLMENT WINDOW (Viewable Monday of Week 7 for upcoming academic quarter)

- Indicates first time you are allowed to enroll in courses.
- When your Enrollment Window opens, you have continuous access to the Enrollment Menu for the next 48 hours.
- After the 48 hours, you may only access WebReg between the hours of 7:00 PM to 7:00 AM.

### FEE STATUS

- Indicates the last day fees are due and whether you have paid them.  
**Note:** *if you fail to pay by the deadline, you will be dropped from all of your classes.*

### STUDY LIST

- Displays courses currently enrolled in.



ENROLLMENT MENU

**WEBREG**  
**UNIVERSITY REGISTRAR**  
**UNIVERSITY of CALIFORNIA - IRVINE**

Search Registrar site:  [GO»](#)

[UCI Home](#) : [Schedule of Classes](#) : [WebReg](#) : [StudentAccess](#) : [Site Index](#)

**Enrollment Menu**

[Logout](#)

[Show Study List](#)

[Go to Wait List Menu](#)

[Return to Main Menu](#)

[Send Request](#)

[Reset](#)

Request	Course Code	Grade Option	Variable Units	Authorization Code
<input checked="" type="radio"/> Add <input type="radio"/> Change	<input type="text" value="44215"/>	<input type="checkbox"/> 1=Grade, 2=P/NP	<input type="checkbox"/>	<input type="checkbox"/>
<input type="radio"/> Drop <input type="radio"/> List Open Sections	<input type="text"/>	Optional: Grade Option, Variable Units, Authorization Code		

- To enroll: Select "Add", input the 5 digit code from WebSOC, and then click "Send Request."
- To drop: Select "Drop", input the 5 digit code from WebSOC, and then click "Send Request."
- To change grade option/units: Select "Change", input the 5 digit code from WebSOC and change request, and then click "Send Request."
- Once changes have been submitted, the system will indicate if further action is needed or if there are any problems. As the following image demonstrates, enrollment in History 15C is not complete until the student enrolls in the corresponding discussion section.

**Enrollment Menu** [Logout](#)

[Show Study List](#)   [Go to Wait List Menu](#)   [Return to Main Menu](#)

[Send Request](#)   [Reset](#)

Request	Course Code	Grade Option	Variable Units	Authorization Code
<input type="radio"/> Add <input type="radio"/> Change	<input type="text"/>	<input type="checkbox"/> 1=Grade, 2=P/NP	<input type="checkbox"/>	<input type="checkbox"/>
<input type="radio"/> Drop <input type="radio"/> List Open Sections	<input type="text"/>	Optional: Grade Option, Variable Units, Authorization Code		

**NOTE :**

---

**you have TENTATIVELY added**

Crse Code	Dept	Crse Num	Sec Typ	Sec Num	Units	Grd Opt	Days	Time	Bldg	Room
28020	HISTORY	15C	LEC	A	4.0	PN	T T	09:30-10:50	HIB	100

**to remain enrolled in this class you must also enroll in : DIS**

## Getting Started

### Important information

---

#### WAITING LIST MENU

- When courses have reached the maximum enrollment, students may waitlist the course if the option is indicated on WebSOC. When you waitlist a course, you are not enrolled but rather placed on a list of students who will be automatically enrolled based on their order on the waitlist as enrolled students drop the course.
- Similar to the Enrollment Menu, in order to remain waitlisted for a course you must waitlist each type of class offered.
- You will be informed through your UCI email if you are enrolled in the course. Make sure to check your UCI email regularly.
- If you no longer wish to enroll in the course, please remove yourself from the waitlist to avoid being accidentally enrolled in the course should enough enrolled students drop. It is your responsibility to make sure that your official class schedule accurately reflects the courses you are taking.

#### AUTOMATIC log off\* WILL RESULT IF:

Exceeding the maximum time (3 minutes of idle time and 12 minutes of activity) Minimizing the window Hitting the <BACK> button \*An automatic log off may result in a delay in disconnecting WebReg from a record resulting in the message "Student record in use, please try again in a few minutes." If this happens, wait about 3-5 minutes then try again



**STUDENT BILLING SYSTEM - Current Account**

This is the Current Account view you'll see on ZOT Account Online. It shows the status of your registration fees, previous and current balances, future credits and debits, minimum amount due, as well as details of all transactions.

You will not receive any paper bills. Instead, it is your responsibility to check your bills on-line at <https://zotaccount.uci.edu/>

**University of California, Irvine Student Billing System**  
Administrative Computing Services

Logout Contact us

**Current Account Information:** (04/13/07 - 05/18/07)  
SPRING 2007 Registration Fees : NOT paid

- You have a Financial Hold. Visit Financial Services' Quick Search at <https://www.fs.uci.edu/QS> or contact Campus Billing Services at 949/UCI-BILL (824-2455).
- Your dean's authorization is now required to register.
- You have a past due balance. Please pay minimum amount due.

**Account Summary**

Amount Due by 05/18/07 after all conditions are met	Minimum payment amount	Previous balance
\$2,602.50		
Past Due Balance	\$2,554.50	Charges incurred during this billing period
Current Charges/Debits	\$50.00	Cash, checks, financial awards, and credits applied during this billing period
Current Payments/Credits	\$2.00 CR	Charges/Debits due in a future billing period
Future Charges/Debits	\$0.00	Future Payments/Credits to be applied in a future billing period
Future Payments/Credits	\$0.00	
<b>Account Balance</b>	<b>\$2,602.50</b>	

**Detailed Transactions** Your total account balance

**Past Due Transactions (Click here for description)**

Trans Date	Paid	Dept.	Description	Reference	Trans. Amount	Due Date	Unpaid
02/16/07		REGISTRAR	SPRING 2007 REGISTRATION FEES	392715	\$2,504.50	03/16/07	\$2,504.50
03/16/07		REGISTRAR	SPRING 2007 LATE REG FEE	148538	\$50.00	04/13/07	\$50.00
<b>Total:</b>							<b>\$2,554.50</b>

**Current Transactions or Credits (Click here for description)**

Trans Date*	Paid or Applied	Dept.	Description	Reference	Trans. Amount	Due Date	Unpaid or Unapplied
12/20/06		CASHIER	PAYMENT TO ZOTACCOUNT	085409	\$1.00 CR		\$1.00 CR
12/20/06		CASHIER	PAYMENT TO ZOTACCOUNT	085412	\$1.00 CR		\$1.00 CR
04/13/07		REGISTRAR	SPRING 2007 LEP FEE CHARGE	022368	\$50.00	05/18/07	\$50.00
<b>Total:</b>							<b>\$53.00</b>

**Future Transactions (Click here for description)**

Trans Date	Paid or Applied	Dept.	Description	Reference	Trans. Amount	Due Date	Unpaid or Unapplied
<b>Total:</b>							<b>\$0.00</b>

**Minimum amount due by 05/18/07 after all conditions are met: \$2,602.50**

Certain forms of aid are designated for disbursement or to pay registration fees only, but not miscellaneous charges.  
Please pay the Amount Due shown here, which takes these situations into account.  
\* Electronic Payments received after the 5:00 pm Pacific Standard Time cutoff will be applied the following day.

Print Payment Stub    Email This Page    Make Payment or Update Profile

You must have Adobe Reader to print stub. Click [here](#) to email this page to yourself or someone else.

## Getting Started

Important information

### BILLING STATEMENTS (ZOTBills)

Billing statements, called ZOTBills, are produced monthly for accounts that have activity or have balances greater than zero. If your account has a balance due or has had activity, your UCI email account will receive an email message reminding that you can view your most recent monthly bill, your current account information, and pay your bill electronically on ZOT Account Online.

If your account had no activity and the balance due is \$0.00, you will not receive an email, but you can view account information on ZOT Account Online twenty-one hours a day, seven days a week. Your ZOTBill is what you see in the Current Account view on ZOT Account Online.

Contact Campus Billing Services: ☎ (949) UCI-BILL (824-2455)

### REGISTRATION FEES

This is the Registration Fee view you'll see on ZOT Account Online.

**University of California, Irvine**  
**Student Billing System**  
Administrative Computing Services

Logout Contact us

### SPRING 2007 Registration Fees : Paid

**FEE PAYMENT DEADLINE: 03/16/2007**

**Warning:**

- Late enrollment penalties apply if you are not enrolled in units by the end of the second week of instruction.

Registration fee is based on:  
**Current enrolled units:** 0 Units  
**Minimum amount due to register:** \$0.00

**Fee related transactions for SPRING 2007, as of 03/27/07**

Trans date	Applied date	Department	Description	Reference	Charge/Debit	Payment/Credit
03/27/07	03/27/07	REGISTRAR	SPRING 2007 REGISTRATION FEES	393350	\$2,504.50	
03/27/07	03/27/07	FIN SVCS	SPRING 2007 PACE	2345678		-\$2,504.50
Total:					\$2,504.50	-\$2,504.50
Minimum amount due to register:					\$0.00	

Tue Mar 27 1

Information about all transactions related to your fees. Click on the links for detailed information.

The number of units in which you are currently enrolled.

The minimum payment amount required. You must pay this amount to avoid penalties and dropped

Minimum payment amount due to register

### PAYMENT INSTRUCTIONS

The Amount Due on the ZOTBill is the minimum payment amount required. Payments can be made electronically from your ZOT Account Online, or by check or money order drawn on U.S. funds and made payable to the REGENTS OF THE UNIVERSITY OF CALIFORNIA or UC REGENTS. Payment must be received by the Cashier by the due date to avoid late charges and other potential consequences.

Contact Central Cashier: ☎ (949) 824-6916

**PACE PAYMENT PLAN (Installment Payments)**

The PACE Plan spreads the costs of registration into three monthly payments over the length of the quarter. A student must apply for and activate a new PACE Plan Agreement each quarter. The Plan is activated when the Central Cashier processes the first installment payment (including the non-refundable participation fee), no later than the applicable registration fee deadline. Until then the current PACE application can be cancelled without penalty.

Each student participant must apply quarterly from ZOT Account Online and must agree to abide by the PACE Terms and Conditions in order to join and remain in the program.

**REGISTRATION AND ENROLLMENT**

Registration fee payment (either electronically or by check or money order along with a payment stub from your ZOT Account Online) must be received by the Central Cashier by 4:30 PM Pacific time on the fee deadline date. If the full amount of registration fees is covered by financial aid or a combination of aid and waivers, and you have enrolled in the Minimum Required Units (MRU), your fees will be paid automatically. If you have partial fee coverage, submit the amount due to the Central Cashier. Failure to meet the fee payment deadline will cause classes added via WebReg to be dropped and late service charges to be assessed.

Contact Registrar: ☎ (949) 824-6124

**FOR NEW STUDENTS**

Holds on New Students' Records

A "hold" is placed on your registration if you are a newly admitted student and the Office of Admissions and Relations with Schools (OARS) has not received the requested documents to verify your conditions of admission stated in your Transfer Conditions (mailed to you with your admissions letter). Requested documents may include official high school transcripts, official transcripts from any college course work, official test scores (SAT I or ACT, SAT II), and official Advanced Placement (AP) and/or International Baccalaureate Higher Level (IB) exam scores. To check the status of sent documents and to see what specific documents OARS still needs, go to Admissions and Relations with Schools and log on to

MyAdmissionsApplication@UCI. Click on "MyTests" and "MySchools."

A "hold" on your record may prevent you from registering. If you have already enrolled, then the hold may drop you from your courses if you do not resolve the hold. Your admission to UC Irvine is subject to cancellation if OARS does not receive the requested official documents or if any information you submitted on your UC application does not agree with the official documents you submit.

Contact Admissions and Relations with Schools:

☎ (949) 824-6703

**FOR STUDENTS WITH FINANCIAL AID**

As soon as you have enrolled in your Minimum Required Units (MRU) and satisfied any conditions noted on your ZOT Account, your aid will be applied to your fees to pay them automatically. The MRU for payment of fees is 6 units for financial aid. It is your responsibility to comply with all terms of the financial aid award before funds can be disbursed. In order to receive financial aid, students are required to pay all University debts, submit all required documents (including on-line entrance counseling materials), and enroll in the MRU. After registration fees and other University obligations are paid, remaining aid will be electronically deposited or mailed, as you designated with the Office of Financial Aid and Scholarships, beginning the first day of the quarter.

Contact Office of Financial Aid and Scholarships:

☎ (949) 824-8262



## Getting Started

### Important information

#### HEALTH INSURANCE - Undergraduate Student Health Insurance

As required by the UC Regents, all undergraduate students are assessed for health insurance as part of their student fees. If you have comparable, verifiable health insurance, you may apply for an exemption (waiver) of this fee using an electronic form available on ZOT Account Online. All waiver applications are handled through ZOT Account Online and instructions are provided. Waivers are due the Friday preceding the fee payment deadline. Additional information on the waiver process is available from the Student Health Center.

Contact Student Health Center Insurance Office: ☎ (949) 824-7093, ☎ (949) 824-4042, or ☎ (949) 824-9415

**STUDENT ACCESS** - <http://www.reg.uci.edu/access/student/welcome/>

Through Student Access, students can view and update their information including past and present coursework, address, view grades, etc.

**UNIVERSITY REGISTRAR**  
UNIVERSITY OF CALIFORNIA - IRVINE

Search Registrar site:  **GO»**

UCI Home ; Schedule of Classes ; WebReg ; StudentAccess ; Site Index

Welcome [Logout](#)

**Enrollment Changes Beginning Fall 2010 - detailed information will be available September:**

- New enrollment deadlines.
- Add/Drop/Change cards will no longer be used.
- An online petition will be used for adds, drops, and changes after enrollment deadlines have passed.

**You can now request a Change of Major through StudentAccess.**  
Click on the Applications link on the left menu bar to submit your request.

**LEVEL:** SENIOR  
**MAJOR(S):** PSYCH & SOC BEHAVIOR  
SOCIOLOGY

The University Registrar's StudentAccess system allows you to view your academic records via the internet 24 hours a day, 7 days a week (excluding downtimes for scheduled maintenance).

The disclosure of information in StudentAccess is governed in large measure by the Federal Family Educational Rights and Privacy Act of 1974 (FERPA), by the State of California Education Code, and by University policy and procedures implementing these laws regarding privacy. For further information, visit the [Privacy](#) section on the University Registrar's website.

To ensure the confidentiality of your student records, your name and other personal identifiers are not displayed in StudentAccess. Records that include personally identifying information, such as official transcripts and enrollment verifications, may be requested from the University Registrar. Refer to the [Services](#) section on our website.

**Remember to logout when finished.** StudentAccess will automatically time out after 30 minutes of inactivity.

**STUDENT AFFAIRS**  
© 2008 UC Regents

UNIVERSITY REGISTRAR  
registrar@uci.edu • tel: (949) 824-6124 • fax: (949) 824-7896  
215 Aldrich Hall • Irvine, CA 92697-4975  
hours: Monday-Friday, 8:00 a.m.-5:00 p.m.

## UNIVERSITY REQUIREMENTS

### UC Entry Level Writing

Can be met prior to UCI entrance by:

- Scoring 3 or higher on AP English (Language or Literature) exam.
- Scoring 680 or better on the Writing section of the SAT Reasoning Test.
- Passing UC Analytical Writing exam.
- Scoring 5 or above on the International Baccalaureate English A exam.
- Completion of one quarter or one semester of English composition with a "C" or better.
- Completion of the CSU English Equivalency test with Pass for two full courses of College English credit.

### American History & Institutions

Can be met prior to UCI entrance by:

- Completing one year of U.S. history OR one semester of U.S. history and one semester of U.S. government in high school (passed with a grade of "C" or better).
- Scoring 3, 4 or 5 on A.P. U.S. History exam.
- Scoring 550 or better on SAT II American History and Social Studies test.

### Unit

Credit for a minimum of 180 quarter units is required to graduate. (Note: Maximum units that can be transferred from community colleges are 105 quarter units).

### Grade

A minimum grade point average of at least "C" (2.0) is required overall and in all of the courses required for the major.

### Residence

At least 36 of the final 45 units completed by a student for the bachelor's degree must be earned in residence at the UCI campus. Participation in a UC EAP program, travel-study, or attending another UC is considered in residence.

## SCHOOL OF SOCIAL SCIENCES REQUIREMENTS

### Math

- All math courses must be taken for grades
- All three-courses sequences
  - ✓ Math 2A-B AND Stats 7
  - ✓ Anthropology 10 A-B-C
  - ✓ Psychology 10A-B-C
  - ✓ Social Science 10 A-B-C
  - ✓ Sociology 10 A-B-C
- Business Economics and Economics majors: Math 2A-2B-4 AND Econ 15A-15B-122A
- Quantitative Economics majors: Math 2A-2B-4-3A and Statistics 120A-120B-120C
- May NOT take Social Science 9 A-B-C to fulfill mathematics requirement

### Computer

- One of the following courses: ICS 31 or Social Science 3A

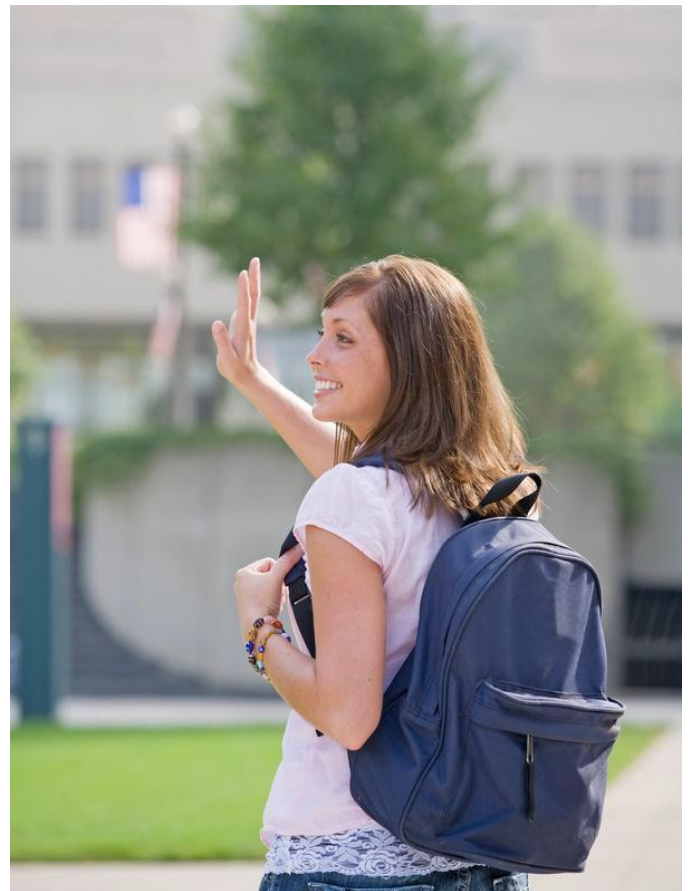

**GENERAL EDUCATION REQUIREMENTS** - Please refer to the General Catalogue for a complete list of courses.

**I. Writing (2 lower-division courses plus 1 upper-division course)**

Because of the importance of writing in every academic discipline, in the professions, and in public life, the University is committed to developing the writing abilities of its students at all levels and in all areas. The Writing Requirement expresses this commitment, but the concern for and attention to clear, accurate writing is expected in all courses.

- Need (2) lower division courses and (1) upper division course.
- Must complete lower division writing before 7th quarter at UCI.
- Must pass the UC Analytical Writing exam before enrolling in courses.
- Courses for writing must be completed with a minimum grade of "C" or better

<b>Humanities Core</b> (Humanities 1A-1B-1C) <ul style="list-style-type: none"> <li>• Yearlong sequence (8 units a quarter)</li> <li>• Deals with major themes in:                         <ul style="list-style-type: none"> <li>✓ History</li> <li>✓ Literature</li> <li>✓ Philosophy</li> <li>✓ Cultural Studies</li> </ul> </li> <li>• Students must complete the writing component of the Humanities Core Course (Humanities 1A-B- C), <b>with a C or better in (1A or 1B) AND in 1C, or for students held for the UC Entry level Writing Requirement, a C or better in 1B AND 1C.</b></li> </ul>		<b>Writing 39B AND 39C, 30, 31, OR 38</b> <ul style="list-style-type: none"> <li>• Two classes: 4 units a quarter</li> <li>• Note: Writing 30, 31, and 38 may only be taken if the student completes Writing 39B with a grade of "B" or better.</li> <li>• Focuses on:                         <ul style="list-style-type: none"> <li>✓ Rhetorical Principles</li> <li>✓ Critical Reading Skills</li> <li>✓ Written analysis of readings</li> </ul> </li> <li>• Offers students more choices with regards to how they complete other General Education requirements</li> </ul>		
Category 1: 2 Lower division writing	Humanities 1A or 1B-1C	Category 1: 2 Lower division writing	Writing 39B AND 39C, 30, 31, OR 38	8 units
Category 4: 3 Arts & Humanities courses	Humanities 1A-1B-1C	Category 4: 3 Arts & Humanities courses	3 approved courses	12 units
Category 7: Multicultural Studies	Humanities 1C	Category 7: Multicultural Studies	1 approved course	4 units
<b>Total Units</b>	24 units	<b>Total Units</b>		24 units





**INCOMPLETE HUMANITIES CORE SERIES**

1. If a student has already satisfied the Entry Level Writing Requirements, and then

- a. passes HUM 1A and leaves HCC: the student has satisfied WR 39B and must take 39C
- b. passes HUM 1A and HUM 1B, and wishes to leave HCC: the student has satisfied WR 39B and must take 39C (effective fall 2011)
- c. passes HUM 1A and HUM 1B, but earns less than a "C" grade in HUM 1C: the student has satisfied WR 39B and must take 39C (effective fall 2011)
- d. passes HUM 1A, earns less than a "C" grade in HUM 1B, and leaves HCC: the student has satisfied WR 39B and must take 39C
- e. passes HUM 1A, earns less than a "C" grade in HUM 1B, and earns less than a "C" grade in HUM 1C: the student has satisfied WR 39B and must take 39C
- f. earns less than a "C" grade in HUM 1A, and leaves HCC: the student must take WR 39B and 39C
- g. earns less than a "C" grade in HUM 1A, passes HUM 1B, and wishes to leave HCC: the student must take WR 39C
- h. earns less than a "C" grade in HUM 1A, passes HUM 1B, and earns less than a "C" grade in HUM 1C: the student must take WR 39C
- i. earns less than a "C" grade in HUM 1A, passes HUM 1B, and passes HUM 1C: the student has satisfied the entire lower-division writing requirement
- j. earns less than a "C" grade in HUM 1A, earns less than a "C" grade in HUM 1B, and leaves HCC: the student must take WR 39B and 39C
- k. earns less than a "C" grade in HUM 1A, earns less than a "C" grade in HUM 1B, and passes HUM 1C: the student must take WR 39B



### 2. If a student has not yet satisfied the Entry Level Writing Requirement, and then

- |  |   |
|--|---|
| <p>a. passes HUM 1A S/A and leaves HCC: the student has satisfied the Entry Level Writing Requirement, and must take WR 39B and 39C</p> <p>b. passes HUM 1A S/A and 1B, and wishes to leave HCC: the student must take WR 39C</p> <p>c. passes HUM 1A S/A and 1B, and earns less than a "C" grade in 1C: the student must take WR 39C</p> <p>d. passes HUM 1A S/A, earns less than a "C" grade in 1B, and leaves HCC: the student must take WR 39B and 39C</p> <p>e. passes HUM 1A S/A, earns less than a "C" grade in 1B, and passes 1C: the student must take WR 39B</p> <p>f. passes HUM 1A S/A, earns less than a "C" grade in 1B, and earns less than a "C" grade in 1C: the student must take WR 39B and 39C</p> | <p>g. earns less than a "C" grade in HUM 1A S/A and leaves HCC: the student must take WR 39A, 39B, and 39C</p> <p>h. earns less than a "C" grade in HUM 1A S/A, passes 1B S/A, and wishes to leave HCC: the student has satisfied the Entry Level Writing Requirement and WR 39B, and must take 39C</p> <p>i. earns less than a "C" grade in HUM 1A S/A, passes 1B S/A, and earns less than a "C" grade in HUM 1C: the student has satisfied the Entry Level Writing Requirement and WR 39B, and must take WR 39C</p> <p>j. earns less than a "C" grade in HUM 1A S/A, passes 1B S/A, and passes HUM 1C: the student has satisfied the Entry Level Writing Requirement, WR 39 B, and WR 39C</p> <p>k. earns less than a "C" grade in HUM 1A S/A and earns less than a "C" grade in 1B S/A: the student must discontinue HCC and take WR 39A, 39B, and 39C</p> |
|--|---|

---

Please note that students who earn an "F" grade in either the lecture or writing section of any quarter of HCC must discontinue the course, so the above rubric does not apply to them. (Students who receive an "F" grade in either lecture or writing in fall or winter may not progress to the next quarter in HCC unless special permission is granted by the Director.)

#### First-Year Integrated Program (FIP)

University Studies 13-17 are three-quarter multidisciplinary sequences for freshmen only. Successful completion of all three quarters will satisfy four courses toward partial fulfillment of different General Education requirement categories. Students must concurrently enroll in Writing 39B either fall or winter quarter and pass it with a grade of "C" or better. Students will receive 5 units a quarter if they complete the courses.

#### University Studies 13A-13B-13C Environmental Studies

- One course toward Category I (equivalent to Writing 39C)
- One course toward Category III (School of Social Sciences majors will satisfy this requirement with their major courses)
- Two courses toward Category II

#### University Studies 15A-15B-15C Consciousness

- One course toward Category I (equivalent to Writing 39C)
- One course toward Category III (School of Social Sciences majors will satisfy this requirement with their major courses)
- Two courses toward Category IV

University Studies 16 A-B-C How Race is Made

- One course toward Category I (equivalent to Writing 39C)
- One to two courses towards Category III\*
- One to two courses towards Category IV\*
- One course towards Category VII
  - ✓ students may choose between category III and IV for one of the GE credits.

University Studies 17 A-B-C Water

- One course towards Category I (equivalent to Writing 39C)
- One course towards Category II
- One course towards Category III (School of Social Sciences majors will satisfy this requirement with their major courses)
- One course towards Category IV

II. Science and Technology (3 courses)

Understanding the nature of scientific inquiry and the operation of the biological, physical, and technological world is essential for making personal and public policy decisions in a technological society. Students must complete three courses from the approved list in the General Catalogue.

III. Social and Behavioral Sciences (3 courses)

Courses will focus on principles, sources, and interpretations of human behavior and on how people organize, govern, understand, and explain social life. This category includes the analysis of human behavior at all levels, from the individual to collective social, economic, and political life, and on the scientific methods used in the acquisition of knowledge and the testing of competing theories.

- Satisfied by majoring in the School of Social Sciences

IV. Arts and Humanities (3 courses)

Study of the Arts and Humanities expands the student's sense of diverse forms of cultural expression, past and present. Students develop their critical capacity as they discover how meaning is created and experience variously interpreted. Students must complete three courses from the approved list in the General Catalogue.

V-A: Quantitative Literacy

V-B: Formal Reasoning (3 courses)

This requirement enables students to evaluate quantitative and symbolic arguments and to model and solve real-world problems using systems of abstract models.

- Completed by Social Sciences Math Requirement

VI. Language Other Than English (up to 3 courses)

Study of a language other than English expands students' horizons by encouraging understanding of another culture through its language and heightens one's own language through the investigation of another linguistic system.

Can be met prior to UCI entrance by:

- 3 years of Foreign Language in high school (must have "C" average in the last year).
- AP score of 3, 4 or 5 in a language other than English
- SAT II score of 570 or better (500 or better in Modern Hebrew)

At UCI, can be satisfied by:

- UCI Exemption Exam (Contact the UCI Testing Center)
- Satisfaction of the 1C level of a language other than English
- EAP approved course of study

**NOTE:** Chicano/Latino Studies majors must take Spanish 2A and International Studies majors must complete the 2C level of one language other than English for a letter grade.

VII. Multicultural Studies (1 course)

This requirement develops students' awareness and appreciation of the history, society, and/or culture of one or more underrepresented groups in California and the United States.

Students must complete one course from the approved list found in the General Catalogue. In fulfilling Category VII, students are encouraged to use courses that are also being used in fulfillment of other GE Categories. For example, Humanities 1C simultaneously satisfies Category VII and a portion of Category IV.

VIII. International/Global Issues (1 course)

Courses in this category focus on significant cultural, economic, geographical, historical, political, and/or sociological aspects of one or more countries other than the United States. Approved courses can be found in the General Catalogue.

In fulfilling Category VIII, students are encouraged to use courses that are also being used in fulfillment of other GE Categories. In addition, Category VIII may be satisfied by one quarter's participation in the Education Abroad Program (EAP).

Overlapping courses between GE Categories:

- Courses applied to Categories II, III, IV, V may not have any overlaps between these Categories
- Courses applied to Categories VII and VIII may overlap with other categories (including Categories II, III, IV, V)



**UCI Career Center**  
 100 Student Services I  
 ☎ Phone: (949) 824-6881  
<http://www.career.uci.edu>

**WHAT CAN I DO WITH A SOCIAL SCIENCES MAJOR?**

This list represents a sampling of industries for Social Sciences majors and is not comprehensive. Please visit the Career Center for assistance and to further research your options.

<p><b>Bank/Finance</b></p> <ul style="list-style-type: none"> <li>- Credit Lending Systems</li> <li>- Trusts Insurance</li> </ul> <p><b>Business</b></p> <ul style="list-style-type: none"> <li>- Consulting</li> <li>- Retail Management</li> <li>- Human Resources</li> <li>- Public Relations</li> <li>- Sales/Marketing</li> <li>- Economist</li> </ul> <p><b>Education</b></p> <ul style="list-style-type: none"> <li>- Teaching</li> <li>- Research</li> <li>- Administration</li> </ul> <p><b>Government</b></p> <ul style="list-style-type: none"> <li>- Corrections</li> <li>- Foreign Service</li> <li>- Political/Economic Affairs</li> <li>- Rehabilitation</li> <li>- Urban/City Planning</li> <li>- Policy Analysis</li> </ul>	<p><b>Law Enforcement</b></p> <ul style="list-style-type: none"> <li>- Special Agent</li> <li>- Computer Security</li> <li>- Forensic Investigations</li> </ul> <p><b>Health Care</b></p> <ul style="list-style-type: none"> <li>- Rehabilitation</li> <li>- Mental Health</li> <li>- Social Services</li> </ul> <p><b>Hospitality</b></p> <ul style="list-style-type: none"> <li>- Sales and Marketing</li> <li>- General Management</li> <li>- Food and Beverage Sales</li> </ul> <p><b>Human Services</b></p> <ul style="list-style-type: none"> <li>- Counseling</li> <li>- Mental Health</li> <li>- Case Management</li> <li>- Social Work</li> <li>- Community Relations</li> </ul>	<p><b>Law</b></p> <ul style="list-style-type: none"> <li>- Paralegal</li> <li>- Public Administration</li> <li>- Judiciary</li> <li>- Lawyer</li> </ul> <p><b>Media/Entertainment</b></p> <ul style="list-style-type: none"> <li>- Writing/Editing</li> <li>- Advertising</li> <li>- Event Planning</li> <li>- Broadcasting</li> <li>- Journalism</li> </ul> <p><b>Travel and Tourism</b></p> <ul style="list-style-type: none"> <li>- Travel/Tour Consultant</li> <li>- Meeting/Convention</li> <li>- Planner Park</li> <li>- Superintendent</li> </ul> <p><b>Museums</b></p> <ul style="list-style-type: none"> <li>- Curator</li> <li>- Conservation</li> <li>- Libraries</li> </ul>	<p><b>Non-Profit</b></p> <ul style="list-style-type: none"> <li>- Public Relations</li> <li>- Administration</li> <li>- Fund Raising</li> <li>- Policy Analysis</li> <li>- Development</li> </ul> <p><b>Politics</b></p> <ul style="list-style-type: none"> <li>- Public Interest</li> <li>- Legislative</li> <li>- Local/State/Federal</li> <li>- Lobby</li> <li>- Campaign</li> </ul> <p><b>Research</b></p> <ul style="list-style-type: none"> <li>- Market Research</li> <li>- Data Analysis</li> <li>- Demography</li> <li>- Education</li> </ul>
--	---	---	--

**STRATEGIES** - These are a few suggestions to prepare you to successfully pursue your career:

1. Obtain an internship or volunteer position in your field of interest to gain experience and skills.
2. Get involved in campus clubs and organizations to develop leadership abilities and expand your network.
3. Attain research experience with a professor or department on campus for desired field.
4. Research occupations to find out education requirements, desired skills, salary, outlook and related jobs.
5. Maintain a good GPA and develop strong personal recommendations with supervisors and professors.
6. Become familiar with the hiring practices for your industry of interest.
7. Take specific classes or add a minor to specialize and advance your skills.
8. Get a full or part-time job to gain time management and customer service skills and responsibility.
9. Prepare for graduate school (if necessary) by researching schools and taking the required admissions tests (i.e. GRE, GMAT, LSAT, etc).
10. Visit the UCI Career Center to learn about choosing/changing your major, the job search process, selecting and applying to graduate school, internship opportunities, interviewing, and resume writing. Information available online (<http://www.career.uci.edu>) and in the UCI Career Center Library (100 Student Services 1).

**CHANGE OF MAJOR REQUIREMENTS** - How do I change/declare/add my major?

You may change/declare/add your major once the quarter has started. However, each School on campus has specific policies and requirements regarding change of majors. It is in your best interest to inquire early as to these requirements. Academic Counselors and Peer Academic Advisors in each school will be able to assist you in this process.

Anthropology, Chicano/Latino Studies, International Studies, and Political Science	
Requirements	Description
Cumulative UC GPA	2.00 GPA and 2.00 GPA for the quarter prior to changing major
Course Grades	<ul style="list-style-type: none"> <li>Completion of at least five courses from the School of Social Sciences. Two of the five courses must be in the student's intended major. All five courses must have a GPA average of 2.00 or better with no grade less than a "C".</li> <li>Option available only for students with 60 or fewer units (excluding AP credits and other units earned prior to high school graduation): At least two courses with 2.3 or better in the student's intended major and no grade less than a "C".</li> </ul>
Business Economics, Economics, Quantitative Economics	
Requirements	Description
Cumulative UC GPA	2.00 GPA and 2.00 GPA for the quarter prior to changing major
Course grades	No grade below a "C" in Math 2A-B and Econ 20A-B, with an average of 2.50 GPA or above.
Psychology	
Requirements	Description
Cumulative UC GPA	2.70 GPA for Option 1 or 2.00 GPA for Option 2 and 2.00 GPA for the quarter prior to changing major
Course Grades	Completion of one of the following options: <ul style="list-style-type: none"> <li>Option 1: Two courses in Psychology with grades of "B-" or better in each course. One of the courses must be from Psychology 7A or 9A-B-C.</li> <li>Option 2: Psychology 9A-B-C and two Psychology core courses with a GPA of at least 3.00 for those five courses.</li> </ul>
Sociology	
Requirements	Description
Cumulative UC GPA	2.00 GPA and 2.00 GPA for the quarter prior to changing major
Course grades	Completion of at least five courses from the School of Social Sciences. Two of the five courses must be in Sociology. All five courses must have a GPA average of 2.30 or better with no grade less than a "C".

How many courses can I overlap if I am a double major or have a minor?

- Double major within the School of Social Sciences: 2 introductory level lower division courses
- Major in the School of Social Sciences and a minor from another school: 2 courses
- Major and a minor in the School of Social Sciences: **NO OVERLAP.**
- No course overlaps between two minors

**MINORS**

A minor consists of a coordinated set of courses (seven or more) which together take a student well beyond the introductory level in an academic field, subject matter, and/or discipline but which are not sufficient to constitute a major. An interdisciplinary minor consists of courses offered by two or more departments, schools, or programs. Generally, all minors are available to all students, with the following exceptions: (1) students may not minor in their major, and (2) students may not complete certain other major/minor combinations that are expressly prohibited, as noted in the Catalogue. Minors are listed on a student's transcript but not on the baccalaureate diploma. If interested, students should contact the School that houses the minor.

<p><b>CLAIRE TREVOR SCHOOL OF THE ARTS</b> Digital Arts Studio Art</p> <p><b>SCHOOL OF BIOLOGICAL SCIENCES</b> Biological Sciences</p> <p><b>THE PAUL MERAGE SCHOOL OF BUSINESS</b> Accounting Management</p> <p><b>DEPARTMENT OF EDUCATION</b> Educational Studies</p> <p><b>THE HENRY SAMUELI SCHOOL OF ENGINEERING</b> Biomedical Engineering Materials Science Engineering</p> <p><b>COLLEGE OF HEALTH SCIENCES</b> Public Health</p> <p><b>DONALD BREN SCHOOL OF INFORMATION AND COMPUTER SCIENCES</b> Biomedical Computing Informatics Information and Computer Science Digital Information Systems Health Informatics Statistics</p>	<p><b>SCHOOL OF HUMANITIES</b> African American Studies Archaeology Art History Asian American Studies Asian Studies Chinese Language and Literature Classical Civilization Comparative Literature English European Studies Film and Media Studies French German Studies Global Cultures Greek History Humanities and Law Italian Studies Japanese Language and Literature Jewish Studies Korean Literature and Culture Latin Latin American Studies Philosophy Portuguese Queer Studies Religious Studies Russian Studies Spanish Women's Studies</p>	<p><b>INTERDISCIPLINARY STUDIES</b> Civic and Community Engagement Global Sustainability History and Philosophy of Science Native American Studies</p> <p><b>SCHOOL OF PHYSICAL SCIENCES</b> Earth and Atmospheric Sciences Global Sustainability Mathematics</p> <p><b>SCHOOL OF SOCIAL ECOLOGY</b> Criminology, Law and Society Environmental Design Psychology and Social Behavior Urban Studies Urban and Regional Planning</p> <p><b>SCHOOL OF SOCIAL SCIENCES</b> Anthropology Chicano/Latino Studies Conflict Resolution Economics Linguistics Medical Anthropology Political Science Psychology Sociology</p>
---	--	---

## CERTIFICATES

### Anthropology

To help provide more focused undergraduate training in anthropology with real-world applications, the Department of Anthropology offers six certificate programs, open to all undergraduates regardless of major. Each is designed to complement a student's other coursework and to provide expertise in a specific area of anthropological inquiry. For more information regarding the department's certificate program, please visit their website at

[www.anthro.uci.edu/undergrad\\_certificates.html](http://www.anthro.uci.edu/undergrad_certificates.html).

- The Certificate in Law and Policy
- The Certificate in Global Studies
- The Certificate in Economy and Culture
- The Certificate in Ethnomusicology
- The Certificate in Gender Studies
- The Certificate in Medical Anthropology

### Sociology

The UCI Sociology Department offers undergraduate Sociology Majors the opportunity to earn up to four departmental certificates. Each certificate recognizes successful completion of a focused course of study in one of four areas. For more information regarding the department's certificate program, please visit their website at

[http://www.sociology.uci.edu/soc\\_undergrad\\_cert](http://www.sociology.uci.edu/soc_undergrad_cert).

- Business, Economy, and Society
- Diversity
- International Sociology
- Planning and Human Services



### Chicano/Latino Studies

The Department of Chicano/Latino Studies offers the opportunity to earn up to three Departmental certificates. Each certificate recognizes successful completion of a focused course of study in one of three areas. Applications and notices of designated University or Departmental events, seminars, and colloquia pertaining to each certificate will be posted on the undergraduate bulletin board on the 3rd floor of Social Science Tower (outside of Social Science Tower 383) and online. The certificate program is available to all majors. For more information on the department's certificate program, please contact Ramón Muñoz at [rrmunoz@uci.edu](mailto:rrmunoz@uci.edu).

- History and Culture Certificate
- Social Policy and Issues
- Chicano/Latino Community in a Global Context

### Middle East Studies

Certificate of Middle East Studies (Interdisciplinary certificate) offered through the Middle East Studies Student Initiative, the certificate offers students the opportunity to develop further understanding of the region. Please contact Kristen Salsbury at 949-824-7161 for more information or visit the website at <http://www.clubs.uci.edu/messi/programs.html>.

## TRANSFER UNITS

To receive credit or units for coursework completed outside of UCI, student must submit official sealed copies of the transcripts or records to UCI Admissions or the Social Sciences Undergraduate Student Affairs (SSUSA). The following includes some tools to determine how California community college coursework may transfer. For coursework taken at a 4-year university or out of state, please contact SSUSA to have them evaluated by an academic counselor (Please refer to the "Petitions" section).



**ASSIST** (<http://www.assist.org>)

ASSIST is an online student-transfer information system that shows how course credits earned at California community colleges can be applied when transferred to the University of California, Irvine. ASSIST is the official repository of articulation for California's public colleges and universities and provides the most accurate and up-to-date information about student transfer in California.

Steps:

1. Go to [www.assist.org](http://www.assist.org).
2. Select your community college from a list of colleges and select a catalogue year.
3. Select "University of California, Irvine".
4. Find courses
  - a. For lower division courses in your major, select your major.
  - b. For Breadth/General Education requirements, select "General Education/Breadth"

This website only lists which courses can be transferred if offered. Students must still refer to the community college's website to find course schedules. Upon completion of the courses, students should request to have an official sealed copy of the transcript sent to UCI Admissions or the Social Sciences Undergraduate Student Affairs (SSUSA).

Courses taken at community colleges can only transfer units and subject credit. Community colleges only offer lower division courses, so all upper division courses must be taken at four year universities. Note that all math courses and major courses must be taken for grades. Refer to "Transcript Notations" for information about unauthorized repeats.

***\*For UC transferable courses, 1 semester unit is equivalent to 1.5 UC quarter units\****



## College Board Advanced Placement

Advance Placement Examination	AP Score	Unit Credit	Credit Allowed Toward Degree
Art			
Art History	3	8	One course toward Art History major, minor, GE category IV from the Art History 40 or 42 series, and satisfaction of GE category VIII plus 4 units of elective credit; may not replace the School of Humanities requirements.
	4 or 5	8	Two courses toward Art History major, minor, category IV of the UCI general education requirement from the Art History 40 or 42 series, and satisfaction of category VIII; may not replace the School of Humanities requirements.
Studio Art <sup>1</sup>			
Drawing	3, 4, or 5	8	Elective credit only.
Two-Dimensional Design Portfolio	3, 4, or 5	8	Elective credit only.
Three Dimensional Design Portfolio	3, 4, or 5	8	Elective credit only.
Biology			
(Non-Biological Sciences Majors)	3, 4, or 5	8	One Biological Sciences course towards category II of the UCI GE Requirements
(Biological Sciences Majors)	3	8	Elective credit only.
(Biological Sciences Majors)	4, or 5	8	Elective credit only.
Chemistry	3	8	Elective credit only.
	4, or 5	8	Chemistry 1A plus 4 units of elective credit.
Chinese Language <sup>2</sup>	3	4	Elective credit only.
	4 or 5	8	Chinese 1A-1B-1C, 2A. Satisfies categories VI and VIII of the UCI GE requirement. Additional course credit may be awarded following placement exam.
Computer Science <sup>3</sup>			
A Exam	3, 4, or 5	4	ICS/CSE 21 or Engineering MAE10.
AB Exam	3	4	ICS/CSE 21 or Engineering MAE10.
	4 or 5	8	ICS/CSE 21 and 22 or Engineering MAE10.
Economics			
Macroeconomics	3	4	Elective credit only.
	4 or 5	4	Economics 20B. May not replace School of Social Sciences requirements for the bachelor's degree.
Microeconomics	3	4	Elective credit only.
	4 or 5	4	Economics 20A. May not replace School of Social Sciences requirements for the bachelor's degree.
English <sup>1</sup>			
	3 (on either or both exams)	8	Elective credit only. Fulfills UC entry level writing requirement.
English Composition and Literature	4 or 5	8	One course toward category IV of the UCI GE requirement from the English 28 series plus 4 units of elective credit; may not replace Literary Journalism major, English major, minor, or School of Humanities requirements.
English Language and Composition	4 or 5	8	Two courses toward category IV of the UCI GE requirement from the English 28 series; may not replace Literary Journalism major, English major, minor, or School of Humanities requirements.
Environmental Science	3	4	Elective credit only.
	4 or 5	8	Social Ecology 8 or Earth System Science 1
French			
French Language	3	8	French 1A-B-C. Satisfies category VI of the UCI GE requirements.
	4 or 5	8	French 2A-B-C. Satisfies categories VI and VIII of the UCI GE requirement.
French Literature	3	8	French 1A-B-C. Satisfies category VI of the UCI GE requirement.
	4 or 5	8	French 2A-B-C. Satisfies categories VI and VIII of the UCI GE requirements.
Geography			
Human Geography	3, 4, or 5	4	Elective credit only.
German Language	3	4	German 1A-B-C. Satisfies category VI of the UCI GE requirement.
	4 or 5	8	German 2A-B-C. Satisfies categories VI and VIII of the UCI GE requirement.

Advance Placement Examination	AP Score	Unit Credit	Credit Allowed Toward Degree
Government and Politics			
American Government	3, 4, or 5	4	Elective credit only.
Comparative			
Comparative Government	3, 4, or 5	4	Elective credit only.
History			
European	3, 4, or 5	8	Elective credit only.
United States	3, 4, or 5	8	Elective credit only.
World	3, 4, or 5	8	Elective credit only.
Italian Language	3 4 or 5	4 8	Italian 1A-B-C. Satisfies category VI of the UCI GE requirement. Italian 2A-B-C. Satisfies categories VI and VIII of the UCI GE requirement.
Japanese Language <sup>2</sup>	3 4 or 5	4 8	Japanese 1A-B-C. Satisfies category VI of the UCI GE requirement. Japanese 2A-B-C. Satisfies categories VI and VIII of the UCI GE requirement.
Latin	3 (on one exam)	4	Elective credit only.
Virgil	3 (on both exams)	8	Latin 1A-B-C. Satisfies category VI of the UCI GE requirement.
Literature	4 or 5 (on one exam) 4 or 5 (on both exams)	4 8	Satisfies categories VI and VIII of the UCI GE requirement. Course credit toward the Classics major, Latin major, or School of Humanities language requirement awarded upon petition. Satisfies categories VI and VIII of the UCI breadth requirement. Course credit toward the Classics major, Latin major, or School of Humanities language requirement awarded upon petition.
Mathematics <sup>1</sup>			
AB Exam	3 4 or 5	4 4	Elective credit only. Mathematics 2A.
BC Exam <sup>4</sup>	3 4 or 5	8 8	Mathematics 2A. Mathematics 2A-2B.
Music Theory	3 4 or 5	8 8	Elective credit only. Elective credit only.
Physics <sup>1</sup>			
Exam B	3, 4, or 5	8	Elective credit only.
Exam C, Part I or II	3 4 or 5	4 4	Elective credit only. Physics 2.
Exam C, Part I (Mechanics)	5	4	Physics 3A.
Exam C, Part II (Electricity and Magnetism)	5	4	Physics 3B.
Psychology	3, 4, or 5	4	Elective credit only.
Spanish <sup>2</sup>			
Spanish Language	3 4 or 5	8 8	Spanish 1A-B-C. Satisfies category VI of the UCI GE requirement. Spanish 2A-B-C. Satisfies categories VI and VIII of the UCI GE requirement.
Spanish Literature	3 4 or 5	8 8	Spanish 1A-B-C. Satisfies category VI of the UCI GE requirement. Spanish 2A-B-C. Satisfies categories VI and VIII of the UCI GE requirement.
Statistics	3, 4, or 5	4	Statistics 7 or Management 7 or Social Ecology 13.

1. Maximum credit is 8 units.
2. Students who wish to enroll in any Chinese, Japanese, or Spanish course at UCI are still required to take the placement examination (and oral interview, if necessary). Students, however, cannot earn units or grade points in courses from which they have been exempted on the basis of Advanced Placement credit, even if placement results require enrollment in such a level.
3. Maximum credit is 4 units.
4. Students who take the Calculus BC examination and earn a sub-score of 3 or higher on the Calculus AB portion will receive credit for the Calculus AB examination, even if they do not receive a score of 3 or higher on the BC examination.

**NOTE:** All students should refer to the information about Duplicate Credit in the General Catalogue.

**HIGHER LEVEL CREDIT**

IB Exam	IB Score	Unit Credit	Credit Allowed Toward Degree
<b>Biology</b>	5, 6, or 7	8	Satisfies one Biological Science course toward category II of the UCI breadth requirement.
<b>Chemistry</b>	5, 6, or 7	8	Elective credit only.
<b>Classical Languages</b>			
Classical Greek	5 6 or 7	8 8	Greek 100A, 103 or 100B, 104 100B, 2 courses of 104
Latin	5 6 or 7	8 8	Latin 100A, 103 or 100B, 104 100A, 2 courses of 103 or 100B, and 2 courses of 104
(Course credit satisfies the School of Humanities foreign language requirement for School of Humanities majors; satisfies categories VI and VIIB of the UCI breadth requirement.)			
<b>Computer Science</b>	5, 6, or 7	8	Satisfies category V of the UCI breadth requirement.
<b>Economics</b>	5, 6, or 7	8	Econ 20A-B satisfies the major requirement for Economics and International Studies; satisfies category III of the UCI breadth requirement.
<b>Environmental Systems</b>	5, 6, or 7	4	Earth Sciences 1 or 25.
<b>Geography</b>	5, 6, or 7	8	Satisfies two Geography courses toward category III of the UCI breadth requirement.
<b>History</b>			
History of the Americas	5, 6, or 7	8	Satisfies two courses toward Hist 40A-B-C for category IV of the UCI breadth requirement.
Non-U.S. exams	5, 6, or 7	8	Satisfies two courses toward Hist 21A-B-C for category IV; satisfies category VIIB of the UCI breadth requirement.
(History exam credit is only applicable toward breadth, not School of Humanities major requirements.)			
<b>Language A1</b> (native language)	5, 6, or 7	8	Satisfies the UC Entry Level Writing Requirement (English exam only).
<b>Language A2</b> (native second language)			
French	5, 6, or 7	8	French 2C
German	5, 6, or 7	8	German 2C
Italian	5, 6, or 7	8	Italian 2C
Portuguese	5, 6, or 7	8	Portuguese 2C
Spanish	5 or 6 7	8 8	Spanish 10A Spanish 10B

(Course credit applies toward the School of Humanities foreign language requirement for School of Humanities majors and International Studies; satisfies both categories VI and VIIB of the UCI breadth requirement.)

IB Exam	IB Score	Unit Credit	Credit Allowed Toward Degree
<b>Language B (non-native language)</b>			
French	5, 6, or 7	8	French 2C*
German	5, 6, or 7	8	German 2C*
Italian	5, 6, or 7	8	Italian 2C*
Portuguese	5, 6, or 7	8	Portuguese 2C*
Spanish	5 or 6 7	8 8	Spanish 2C Spanish 10A
* Additional course credit may be awarded toward the major, upon petition. (Course credit applies toward the School of Humanities foreign language requirement for School of Humanities majors and International Studies; satisfies both categories VI and VIIB of the UCI breadth requirement.)			
<b>Mathematics</b>	5, 6, or 7	8	Elective credit only.
<b>Music</b>	5, 6, or 7	8	Eligibility to take Placement Test for Theory and/or History for course credit.
<b>Philosophy</b>	5, 6, or 7	8	Elective credit only.
<b>Physics</b>	5, 6, or 7	8	Satisfies two Physics courses toward category II of the UCI breadth requirement.
<b>Psychology</b>	5 6 or 7	8 8	Satisfies category III of the UCI breadth requirement. Psych 9A-B-C satisfies major requirement for Psychology; satisfies category III of the UCI breadth requirement.
<b>Social &amp; Cultural Anthropology</b>	5, 6, or 7	8	Anthro 2A satisfies the School requirement for School of Social Sciences majors; satisfies one Anthropology course toward category III, and one course toward category VIIB of the UCI breadth requirement.
<b>Theater Arts</b>	5, 6, or 7	8	Elective credit only.
<b>Visual Arts</b>	5, 6, or 7	8	Elective credit only.
<b>Diploma Programme</b>	Up to 30*		

The programme includes six IB exams, with varying breadth and/or course credit.

\*Students are granted 30 units if they earn 30 total Diploma Programme points.

*Elective Credit* : Elective credit is awarded in cases where breadth and/or UCI course credit does not apply.

*Duplicate Credit* : Students should be aware that IB exams, AP exams, and college courses taken prior to or after enrolling at the University may be duplicative. In these cases, the University will award credit for only one of these.

*Credit Limitation* : A student may receive eight units maximum for Higher Level IB exams that are duplicative.

## STUDENT AFFAIRS OFFICE FUNCTIONS

### Whom do I speak with?

It depends on what you need! The School of Social Sciences does not assign specific advisors so you can meet with any one of our Academic Counselors or Peer Academic Advisors to find the answers you need.

**Front Desk (Walk-In)** - a Peer Academic Advisor and an Academic Counselor to answer quick questions, direct you to the correct resource, schedule appointments with Academic Counselors, and provide forms regarding excess unit request, prerequisite clearance, change of majors, post-quarter add/drop/changes, and part-time student applications.

**Peer Academic Advisors (Walk-In)** - questions regarding unofficial degree checks, class schedules, general education, school, and major requirements, change of major process, petitions, and application to graduate.

- To talk to a Peer Academic Advisor you may come in during office hours for walk-in advising.

**Academic Counselors (Appointment/Walk-In)** - official graduation degree check, petitions, academic contracts or if you have any sort of IGETC related questions.

- Appointments with Academic Counselors are only scheduled for declared students who are majors in the School of Social Sciences. To schedule an appointment with an Academic Counselor please call (949) 824-6803.

## STUDY ABROAD ADVISING

- Prospective Education Abroad Program (EAP) participant- Walk-in advising only from 8:30 AM to 9:30 AM Monday through Friday. Bring copies of the course descriptions to have your courses evaluated once you have chosen one specific program.
- Prospective International Opportunities Program (IOP) participant- Walk-in advising only from 8:30 AM to 9:30 AM Monday through Friday. The IOP Advance Contract online must be evaluated by UCI Admissions **before** our office can evaluate the courses.

- EAP/IOP Returner- Call (949) 824-6803 to schedule an appointment with an EAP/IOP Academic Counselor once grades have been posted on your UCI transcript (for EAP students) or official transcripts have been received (for IOP students). Make sure to bring course syllabi to the appointment.

## ACADEMIC PROBATION/CONTRACT

What are Academic Probation and Academic Contract? Good academic standing at UCI is maintaining quarterly and cumulative grade point averages (GPAs) of at least 2.00. If either GPA falls below 2.00, the student should contact the Social Sciences Undergraduate Student Affairs Office as soon as possible to determine their status and whether action is necessary to avoid disqualification. The two main phases before disqualification are Academic Probation and Academic Contract.

### Academic Probation

When a student's quarterly GPA falls below 2.00 but their UC cumulative GPA is still above 2.00, the student is placed on Academic Probation. No action is taken but this serves as a warning.

### Academic Contract

There are two situations which place a student on academic contract.

- Two consecutive quarterly GPAs below 2.00
- UC cumulative GPA below 1.80

An email will be sent to you regarding your Academic Contract. Do not ignore the email. It will serve as your contract if you do not come into the SSUSA to see an Academic Counselor. If you have any questions or would like to discuss the terms of the Academic Contract, please call to schedule an appointment at (949)824-6803. If the student satisfies the terms of the Academic Contract, then the student may be off contract or the contract may be extended, depending on the student's overall progress. Meeting the terms of the Academic Contract ensures the student's eligibility to continue as a UCI student for the upcoming academic quarter.

If the student violates the contract, the record will be reviewed again to determine whether the student will be disqualified. The student in this situation should contact the SSUSA to determine their status as soon as possible.

## DEAN'S SIGNATURE

Academic Counselors in the Social Sciences Undergraduate Student Affairs Office (SSUSA) are authorized to sign for the Dean of Social Sciences. Therefore, if any forms, including readmission, part-time student petition, etc. require the Dean's Signature, please come to the Social Sciences Undergraduate Student Affairs Office (SSUSA). Contact the Registrar for verifications of enrollment and grades.

## CANCELLATION/WITHDRAWAL

Undergraduate students who pay fees for a regular academic quarter and then decide to withdraw from the University must submit a Cancellation/Withdrawal form to the Office of the Registrar after obtaining the signature of their academic dean (available at the Social Sciences Undergraduate Student Affairs Office (SSUSA) for students affiliated in the School of Social Sciences). This form serves two purposes: (1) a refund of fees, if applicable; and (2) automatic withdrawal from all classes. The effective date of withdrawal is used in determining the percentage of fees to be refunded. A "W" grade will be recorded for each course in which enrollment is withdrawn if the student's effective date of withdrawal is after the end of the sixth week of classes.

New undergraduate students are encouraged to seek advice from their admissions or academic advisor to understand the consequences of withdrawal and their eligibility to return, before submitting the form (Please refer to the Readmission section).

If an undergraduate student plans to leave the University after completing all academic work for the latest quarter of enrollment and has not paid fees or enrolled for the next quarter, a formal notice of withdrawal is not necessary.

## READMISSION

### All Students

Readmission is subject to Dean's signature/approval (available in the Social Sciences Undergraduate Student Affairs Office (SSUSA) for students affiliated with the School of Social Sciences) and campus deadlines (August 1 for Fall Quarter, November 1 for Winter Quarter, and February 1 for Spring Quarter). To apply for readmission, a student must first visit their academic advising office to obtain the Dean's signature. The application is on-line and will be submitted by an academic counselor upon

approval. The \$70 application fee will be added to a student's Zot Bill within two to three days of being approved for readmission.

### New Undergraduate Students

New undergraduate students who cancel registration prior to the first day of the quarter must reapply to UCI; they are not eligible to file for readmission as described above.

### Former UCI Students

Former UCI students who wish to be readmitted should contact the undergraduate advising office of the school or program which offers their intended major.

### Poor Academic Standing

If a student has been academically disqualified from the University or has left the University while on probation or subject to disqualification, the student must apply for readmission. The application is subject to the approval of the Dean of the School which the student hopes to enter. Transcripts for work taken at other institutions must be submitted as part of the application.

### Part-Time Student Status

A student with full-time student status must be enrolled in a minimum of 12 units. A student enrolled in less than 12 units will lose their full-time student status, but still pay the full-time fees unless a Petition for Reduced Fee Part-Time Study Program has been submitted by the deadline.

The School of Social Sciences only accepts three reasons for petitioning for reduced fees as a part-time student and requires appropriate documentation:

- Health
- Family obligation
- Work (Student must work a minimum of 25 hours a week to qualify)

If the student qualifies, they must bring in the documentation to the Social Sciences Undergraduate Student Affairs Office (SSUSA) and fill out the Petition for Reduced Fee Part-Time Study Program. Once approved, the student must submit the Petition to the Office of the Registrar no later than 5:00 p.m. Friday, the end for the third week of classes, to be eligible for reduced fees.

### HOW LONG DO I HAVE TO ADD/DROP/CHANGE CLASSES?

To drop or add or change the grading option on a course, you use WEBREG at <http://www.reg.uci.edu/registrar/soc/webreg.html>

Please note the below deadlines that are effective for the UCI campus effective Fall 2010.

### Dropping a Course

The deadline to DROP a course is Friday at 5:00 PM of week 2 in the current quarter.

### Adding a Course

The deadline to ADD a course is Friday at 5:00 PM of week 3 in the current quarter.

### Changing a Course Grading Option (Grade to Pass / No Pass or Pass / No Pass to Grade)

For majors in the School of Social Sciences, the deadline to change your grading option is by 5:00 PM of week 6 in the current quarter. The Dean's approval will not be given after week 6.

### WHEN CAN I RE-TAKE A CLASS?

### HOW MANY CAN I RE-TAKE?

Classes cannot be retaken unless the grade earned was a "C-" or lower. The first 16 units retaken will replace the grades and units completely when calculated into the UCI GPA. The most recent grade will always replace the previous grade regardless of which grade is better, if it is within the first 16 units retaken. After the first 16 units, the old grade and the new grade will be averaged when calculated into the UCI GPA. The original and subsequent grades will all remain noted on the transcript.

### TRANSCRIPT NOTATIONS

**UR - Unauthorized Repeat.** If a student repeats a course for which a passing grade ("C" or better) has already been received and the course is not approved as repeatable for credit, the student will receive a —UR and no credit, grade, or units will be given.

**"NR" — "No Record".** This turns into an "F" if it is not taken care of within one quarter.

**"I" — "Incomplete".** This means that your professor did not have enough coursework to determine your grade. Incomplete grades are only issued to a student who for a medically documented reason or some other documented reason was unable to complete an assignment or exam. Once you make up the work within the time agreed upon by the instructor, you will be issued a grade. Effective Fall 2010, any Incomplete grades that have not been changed within three quarters will automatically lapse to a grade of "F" on your

transcript. Note you do not enroll in the course again, but complete the work with the professor's approval and then receive a grade change with the help of the SSUSA.

**"W" — "Withdrew from Course".** This means that you dropped the course after the drop deadline.

### PETITIONS

Students petition to receive credit for courses not preapproved on Assist.org or articulated in the catalogue.

Online petition (additional paperwork or documentation not required)

- Use a computer to access the web and enter the following URL:  
<http://undergraduatestudies.ss.uci.edu/>
- Click on —Forms & Policies link.
- Click on —Academic Petition link.
- Complete the form and submit.

A decision on your electronic petition will be completed in 3-5 business days. If you have any questions, please contact the Social Sciences Undergraduate Student Affairs Office at (949) 824-6803 or via email at [socsci@uci.edu](mailto:socsci@uci.edu).

Paper Petition (additional paperwork or documentation required)

- Please bring in paperwork (i.e., course descriptions, syllabi, etc.) to our office.
- Fill out the paper petition in our office. We will contact you by phone or email you with the results.

### PREREQUISITE CLEARANCE

Why can't I enroll in a class, when I have met the prerequisites and am a major?

If you have a problem enrolling in a class and have met all prerequisites for the course, please come in to fill out a prerequisite clearance form.

Students, especially transfer students, need to come in to fill out prerequisite clearance forms if prerequisites (lower division writing, psychology, economics, etc.) were taken at another school or other institution (ex. AP scores) for each quarter they have a class that requires those courses as prerequisites. Please come before your enrollment window opens to avoid any complications with enrollment.



**SOCIAL SCIENCES ACADEMIC RESOURCE CENTER (SSARC)**

The Social Sciences Academic Resource Center was created over a decade ago to help School of Social Sciences students obtain the appropriate information to select a career and/or graduate school program, generate professional contacts and learn how to gain a competitive edge during their undergraduate years.

The Social Sciences Academic Resource Center provides valuable resources for undergraduates in the School of Social Sciences and is conveniently located across from the Social Sciences Office of Student Affairs in the Social and Behavioral Sciences Gateway building. Friendly and knowledgeable SSARC staff can guide you to the information you need in a relaxed, pleasant environment.

- Resume Critique
- Internship Workshop
- Research
- Leadership Opportunities
- Graduate School Information
- Statement of Purpose Workshop

Monday – Friday

9:00 A.M. – 5:00 P.M.

1230 Social & Behavioral Sciences Gateway

☎ Phone: (949) 824-8322

✉ E-mail: [ssarc@uci.edu](mailto:ssarc@uci.edu)

🌐 Web: [www.socsci.uci.edu/ssarc](http://www.socsci.uci.edu/ssarc)

**LEARNING AND ACADEMIC RESOURCE CENTER (LARC)**

The Learning and Academic Resource Center provides services designed to help students acquire the skills they need to develop intellectually, become successful learners, and achieve their academic and professional goals. LARC staff and programs provide students with the personal contact and support needed for academic success on a large and diverse campus. The Center works closely with faculty to develop programs that meet both curricular objectives and the changing needs of students. LARC programs stress the development of academic abilities that all university students need regardless of major: effective study strategies, critical reading and analytical writing. The Center offers adjuncts classes, workshops, peer-tutoring groups, and individual counseling, including assistance in all forms of academic reading and writing.

Monday – Friday

8:00 A.M. – 5:00 P.M.

284 Rowland Hall

☎ Phone: (949) 824-6451 | 🌐 Web: [www.larc.uci.edu](http://www.larc.uci.edu)

**UCI ACADEMIC TESTING CENTER**

The UCI Academic Testing Center, a unit within the Division of Undergraduate Education, administers the Placement Testing Program to new and continuing students to ensure correct placement in selected introductory courses and to help students assess their readiness for University-level work. These tests are selected or developed by UCI faculty who also determine the grading criteria for each test. Students, with the help of academic counselors, use results from placement tests to determine enrollment in introductory courses and to formulate a plan of study that is best suited for their learning needs and career goals.

Placement tests are currently given in the areas of chemistry, physics, calculus, mathematical analysis, Chinese, Japanese, Korean, Vietnamese, Analytical Writing, and Academic English.

The Academic Testing Center also administers the Language Testing Program. Tests are offered in over 40 languages and are administered 3 times during the academic year.

The Academic Testing Center participates with the Composition Program in the campus-based administration of the University of California Analytical Writing Placement Exam.

Monday – Friday

9:00 A.M. – 5:00 P.M.

3040 Anteater Instruction and Research Building

☎ Phone: (949) 824-6207

☎ Fax: (949) 824-3832

✉ E-mail: [testcenter@uci.edu](mailto:testcenter@uci.edu)

🌐 Web: [www.testingcenter.uci.edu](http://www.testingcenter.uci.edu)



### UCI CAREER CENTER

Students are strongly encouraged to visit UCI's Career Center early in their academic career. The Center assists undergraduate and graduate students with career decision-making and career planning through individual counseling, workshops, career programs, career fairs, employment opportunities, and graduate and professional school information. Vocational interest inventories are also available on a fee-for-service basis. The center provides students many opportunities to connect with employers, alumni, and professional and graduate schools. The Center assists students seeking part-time and full-time employment opportunities, teaches job search skills and interviewing techniques; and provides job listings and offers an on-campus interview program (OCI).

Monday – Friday

8:00 A.M. – 5:00 P.M.

100 Student Services 1 (Across from Starbucks)

☎ Phone: (949) 824-6881

✉ E-mail: [career@uci.edu](mailto:career@uci.edu)

🌐 Web: [www.career.uci.edu](http://www.career.uci.edu)

### UNDERGRADUATE RESEARCH OPPORTUNITIES PROGRAM (UROP)

The Undergraduate Research Opportunities Program (UROP) in the Division of Undergraduate Education encourages and facilitates faculty-mentored research and creative activities by undergraduates from all schools and academic disciplines at UCI. UROP also collaborates with various schools and research units to develop specialized research opportunities. Conducting research and creative activities has become an integral component of the education undergraduates receive at UCI, and provides students with the necessary skills to succeed in their future careers. Research opportunities are available not only from every discipline, interdisciplinary program, and school, but also from many outside agencies, including national laboratories, industrial partners, and other universities. Opportunities are listed on the UROP website, and distributed through various e-mails throughout the academic year. Students interested in receiving more information and individualized assistance are encouraged to contact the UROP Office to set up an advising appointment.

Through UROP's various programs, the UROP Team assists students through all phases of the research process, whether it is with proposal writing, developing research plans through project management skills, receiving grants to fund research projects, scholarly

journal writing through The UCI Undergraduate Research Journal, or presenting results of the research or creative project through the UCI Undergraduate Research Symposium.

Monday – Friday

9:00 A.M. – 5:00 P.M.

2300 Student Services II

☎ Phone: (949) 824-4189

✉ Fax: (949) 824-1607

✉ E-mail: [urop@uci.edu](mailto:urop@uci.edu)

🌐 Web: [www.urop.uci.edu](http://www.urop.uci.edu)

### COUNSELING CENTER (Non-Academic)

The Counseling Center is here to provide the UCI community with a broad range of mental health support services. They include: individual, couples, and group counseling, urgent care, crisis response, consultation, and outreach programs.

The Counseling Center is committed to helping students achieve the maximum benefit from their UCI experience. The Center's intention is to support students in performing well academically, to assist them through developmental tasks associated with their college student years, and to learn how to be more effective in developing, maintaining, and negotiating relationships with others. The Center is also committed to managing psychological crises which arise as a result of students' inability to cope with the pressures associated with a stressful academic environment.

The services offered by the Counseling Center are free of charge and available to all currently enrolled students. Services can be grouped into four areas: counseling and psychotherapy; workshops; academic instruction; training and consultation.

The Counseling Center is open from 8am to 5pm, Monday through Friday for scheduled appointments and a counselor is always available on an urgent basis. If you would like to talk with someone or make an appointment for counseling services please call (949) 824-6457.

Monday – Friday

8:00 A.M. – 5:00 P.M.

203 Student Services I

☎ Phone: (949) 824-6457

🌐 Web: [www.counseling.uci.edu](http://www.counseling.uci.edu)

## STUDENT HEALTH CENTER

Effective Fall Quarter 2001, the Regents of the University of California instituted health insurance coverage as a condition of enrollment for all undergraduate students. This insurance is now included in your student fees and enrollment in the plan is automatic when you pay your fees. You may waive out of this plan if you can demonstrate comparable and verifiable health coverage that meets the campus' minimum standards for insurance. (Refer to "Health Insurance") The Student Health Center is the primary care facility for students covered by the USHIP. In order to take advantage of your insurance plan, all medical care must begin at Student Health. If you need a medical service that we cannot provide, you will be referred to a qualified provider in the community. If you are a member of USHIP, the cost of your medical care will be billed directly to your insurance plan. Students who waive out of the plan, but use Student Health, will pay at the time of service and will be given an itemized receipt they may submit to their insurance carrier for reimbursement.

Monday – Friday

7:30 A.M. – 5:30 P.M. *(closed on all UCI holidays)*

501 Student Health

☎ Phone: (949) 824-5301

☎ Fax: (949) 824-3033

🌐 Web: [www.shs.uci.edu](http://www.shs.uci.edu)



## DEAN OF STUDENTS

### STUDENT LIFE & LEADERSHIP

The mission of the Office of the Dean of Students is to provide services, programs, and facilities that enhance the quality of education by extending the learning environment beyond the classroom and into the co-curricular lives of UCI students. The Office of the Dean of Students promotes student participation in campus life and advocates for needs that are valued by students and

validated by campus objectives. The Office of the Dean of Students also promotes an active college lifestyle and encourages students to take advantage of opportunities to get involved with the university and student organizations. It is recommended, however, that all students maintain an awareness of balancing all aspects of college life and be educated about the programs with which they choose to participate.

### UCI Campus Organizations

🌐 <http://campusorgs.uci.edu/>

### Social Sciences Outreach Programs

🌐 [http://www.socsci.uci.edu/ss\\_community](http://www.socsci.uci.edu/ss_community)

### Monday – Friday

8:00 A.M. – 5:00 P.M.

G308 Student Center

☎ Phone: (949) 824-5181

☎ Fax: (949) 824-3412

☎ E-mail: [deanstu@uci.edu](mailto:deanstu@uci.edu)

🌐 Web: [www.dos.uci.edu](http://www.dos.uci.edu)

## STUDY ABROAD CENTER

The Study Abroad Center includes the Education Abroad Program (EAP) and the International Opportunities Program (IOP). Study Abroad Center is a comprehensive resource and counseling center which helps students take advantage of the many worldwide opportunities that exist for study, work, internship, volunteering, research, and non-credentialed teaching which relates to their degree programs at UCI.

Professional staff and international peer advisors, who have returned from an IOP or EAP experience, are available to guide students in making appropriate choices of international programs for their educational goals. Group and individual advising is available every day that UCI is in session.

Please refer to the EAP/IOP Preparation Guidelines on the next page.

### Monday – Friday

9:00 A.M. – 4:00 P.M.

1100 Student Services II

*(across Ring Road from the UCI Bookstore)*

☎ Phone: (949) 824-6343

☎ Fax: (949) 824-9133

☎ E-mail: [studyabroad@uci.edu](mailto:studyabroad@uci.edu)

🌐 Web: [www.studyabroad.uci.edu](http://www.studyabroad.uci.edu)

**EAP/IOP** (*Preparing to Study Abroad in the Junior Year*)

The schedule listed below consists of courses we recommend students complete by the end of their sophomore year, if they are considering studying abroad in their junior year. This is NOT a complete list of courses students should take each year but the minimum courses necessary to continue making normal progress. Students should refer to the General Education and major specific information or the General Catalogue to find additional courses to take. Students take an average of 16 units a quarter.

After choosing a specific study abroad program, the SSUSA assists students in evaluating the coursework taken abroad (Please see the table below).

Major	Freshmen	Sophomore
Anthropology	<ul style="list-style-type: none"> <li>• Lower division writing (GE Category I)</li> <li>• Anth. 2A</li> <li>• Anth. 2B, 2C, or 2D</li> <li>• Soc. Sci. 3A</li> </ul>	<ul style="list-style-type: none"> <li>• Anth. 30A or 30B</li> <li>• Anth. 10ABC or Soc. Sci. 10ABC</li> </ul>
Chicano/Latino Studies	<ul style="list-style-type: none"> <li>• Lower division writing (GE Category I)</li> <li>• Chicano/Latino Studies 61, 62, and 63</li> <li>• Soc. Sci. 3A</li> </ul>	<ul style="list-style-type: none"> <li>• Soc. Sci. 10ABC</li> <li>• Spanish 2A</li> </ul>
Economics/Business Economics	<ul style="list-style-type: none"> <li>• Lower division writing (GE Category I)</li> <li>• Econ. 20A and 20B</li> <li>• Math 2A, 2B, and 4</li> </ul>	<ul style="list-style-type: none"> <li>• Econ. 100ABC</li> <li>• Econ. 15A-15B, 122A</li> </ul>
Quantitative Economics	<ul style="list-style-type: none"> <li>• Lower division writing (GE Category I)</li> <li>• Econ. 20A and 20B</li> <li>• Math 2A, 2B, 4, and 3A</li> </ul>	<ul style="list-style-type: none"> <li>• Econ. 105ABC</li> <li>• Stats. 120ABC</li> </ul>
International Studies	<ul style="list-style-type: none"> <li>• Lower division writing (GE Category I)</li> <li>• Intl Stu 11, 12, and 13</li> <li>• Soc. Sci. 3A</li> </ul>	<ul style="list-style-type: none"> <li>• Soc. Sci. 10ABC</li> <li>• Language other than English up to 2B level</li> </ul>
Political Science	<ul style="list-style-type: none"> <li>• Lower division writing (GE Category I)</li> <li>• Lower division Political Science core (2 or 3 courses)</li> <li>• Soc. Sci. 3A</li> </ul>	<ul style="list-style-type: none"> <li>• Soc. Sci. 10ABC</li> <li>• Lower division Political Science core (3 or 2 courses)</li> </ul>
Psychology	<ul style="list-style-type: none"> <li>• Lower division writing (GE Category I)</li> <li>• Psychology 9A, 9B, and 9C</li> <li>• Soc. Sci. 3A or equivalent</li> </ul>	<ul style="list-style-type: none"> <li>• Soc. Sci. 10ABC or Math 2A-B and Stats 7</li> </ul>
Sociology	<ul style="list-style-type: none"> <li>• Lower division writing (GE Category I)</li> <li>• Sociology 1</li> <li>• Sociology 2 or 3</li> <li>• Soc. Sci. 3A</li> </ul>	<ul style="list-style-type: none"> <li>• Sociology 10ABC or Soc. Sci. 10ABC</li> </ul>
Social Sciences	<ul style="list-style-type: none"> <li>• Lower division writing (GE Category I)</li> <li>• Soc. Sci. 1A, 3A, and 12A</li> </ul>	<ul style="list-style-type: none"> <li>• Soc. Sci. 10ABC</li> </ul>

**Education Abroad Program (EAP)**

1. Pick up your application from the Study Abroad Center
2. Consult EAP course finder: <http://eap.ucop.edu/coursefinder>
3. Print out all course descriptions
4. OPTIONAL: Bring all course descriptions to SSUSA between 8:30AM – 9:30AM to meet with an Study Abroad Counselor

**International Opportunities Program (IOP)**

1. Contact CIE for link for online IOP Advance Contract
2. Complete the online IOP Advance Contract
3. Once it is reviewed by Admissions, a message is sent to an Academic Counselor who will review the information online.

Make sure to bring back the course syllabi for all courses taken abroad. Once the transcripts have been processed, please call to schedule an appointment (949) 824-6803 for the final evaluation with SSUSA.

## UCDC / UC SACRAMENTO ACADEMIC INTERNSHIP PROGRAMS

The UCDC Academic Internship Program is offered during the Fall, Winter, and Spring quarters. Students who intern in D.C. during the academic year combine internships with coursework or field research as full-time students. Financial aid eligibility is maintained and may also qualify for the Presidential Scholarship. Students from all majors are encouraged to apply, Juniors and Seniors with a minimum GPA of 3.0 is recommended. For more information on the UCDC Academic Internship Program, please visit: [www.dccenter.uci.edu](http://www.dccenter.uci.edu).

The UCDC Summer Internship Program sends students to Washington D.C. during the summer for experiential learning only. Each student admitted into the UCDC Summer Internship Program works closely with the Student Coordinators and Staff Advisors in preparation for the internship application and living experience in D.C. Students from all majors and class standing (including graduating seniors) are encouraged to apply. A minimum GPA of 2.5 is recommended.

The UCI Sacramento Internship Program allows students to experience and explore a wide variety of career opportunities available to them with the convenience of staying close to home (or without traveling out of state) this summer. It is an especially great program for those who are interested in public policy at the state level and want to be exposed to California laws and decisions up close. However, the internship opportunities are not limited to strictly political experiences. This Program is best for students who are looking for an Internship during the summer if they do not want to miss an academic quarter. It is also not an academic program so there will be no coursework involved, however students may be able to receive units for their academic school. For more information, please visit: [www.statecap.uci.edu](http://www.statecap.uci.edu).

### Monday – Friday

9:00 A.M. – 5:00 P.M.

100 Student Services I

☎ Phone: (949) 824-6886

🌐 Web: [www.ucdc.uci.edu](http://www.ucdc.uci.edu)

## INTERNATIONAL CENTER (IC)

The International Center is a part of the Office of the Dean of Students at the University of California, Irvine. The IC staff counsels and assists international students, faculty, researchers, staff and scholars with immigration, orientation, employment and adjustment needs throughout their stay at the University of California,

Irvine. In addition, the IC staff brings together international and American members of the UCI community for a variety of cultural, educational, social and recreational activities. The International Center helps visiting students, staff and scholars from other countries with any concerns that develop during their time at UCI. International students admitted to a UCI program of study and visiting international faculty, staff and scholars should address correspondence about immigration or other related concerns to the International Center.

### Monday - Friday

8:00 A.M. – 5:00 P.M.

500 East Peltason Dr.

☎ Phone: (949) 824-7249

☎ Fax: (949) 824-3090

✉ E-mail: [intl@uci.edu](mailto:intl@uci.edu)

🌐 Web: [www.ic.uci.edu](http://www.ic.uci.edu)

## CROSS-CULTURAL CENTER

The mission of the Cross-Cultural Center (CCC) is to provide opportunities for University of California, Irvine students to affirm their cultural identities, develop their leadership skills, learn about UCI's various multicultural communities, and take active approaches in creating a socially just campus community. We strive to create and maintain meaningful dialogues and interactive programs across and between all cultures, particularly those of underrepresented, underserved, and underprivileged backgrounds. We provide a network of support for our diverse students in order to enhance their personal, social, cultural, and academic wellbeing, and promote an environment that encourages intellectual exchange, civility, and the responsible exercise of individual expression.

### Monday – Friday

8:00 A.M. – 5:00 P.M.

☎ Phone: (949) 824-7215

☎ Fax: (949) 824-3056

🌐 Web: [www.ccc.uci.edu](http://www.ccc.uci.edu)

## REGISTRATION (WebReg)

🌐 Web: [www.reg.uci.edu/registrar/soc/webreg.html](http://www.reg.uci.edu/registrar/soc/webreg.html)

## SCHEDULE OF CLASSES (WebSOC)

🌐 Web: [websoc.reg.uci.edu/perl/WebSoc](http://websoc.reg.uci.edu/perl/WebSoc)

## STUDENT ACCESS

🌐 Web: [www.reg.uci.edu/access/student/welcome/](http://www.reg.uci.edu/access/student/welcome/)

## CAMPUS OPERATOR

☎ Phone: (949) 824-5011

**ADMISSIONS OFFICE**

Monday – Friday  
8:00 A.M. – 5:00 P.M.  
260 Aldrich Hall  
☎ Phone: (949) 824-6703  
☎ Fax: (949) 824-2951  
🌐 Web: [www.admissions.uci.edu](http://www.admissions.uci.edu)

**FINANCIAL AID OFFICE**

Monday – Friday 10:00 A.M. – 5:00 P.M. 102 Aldrich Hall  
☎ Phone: (949) 824-8262  
☎ Fax: (949) 824-4876  
🌐 Web: [www.ofas.uci.edu](http://www.ofas.uci.edu)

**HOUSING SERVICES**

Monday – Friday  
8:00 A.M. – 5:00 P.M.  
G465 Student Center  
☎ Phone: (949) 824-7247  
✉ E-mail: [housing@uci.edu](mailto:housing@uci.edu)  
🌐 Web: [www.housing.uci.edu](http://www.housing.uci.edu)

**OFFICE OF THE REGISTRAR**

Monday – Friday  
8:00 A.M. – 5:00 P.M.  
215 Aldrich Hall  
☎ Phone: (949) 824-6124  
☎ Fax: (949) 824-7896  
✉ E-mail: [registrar@uci.edu](mailto:registrar@uci.edu)  
🌐 Web: [www.reg.uci.edu](http://www.reg.uci.edu)

**CENTRAL CASHIER**

Monday – Friday  
8:00 A.M. – 5:00 P.M.  
228 Aldrich Hall  
☎ Phone: (949) 824-6916  
☎ Fax: (949) 824-3252  
✉ E-mail: [cashiers@uci.edu](mailto:cashiers@uci.edu)  
🌐 Web: [www.fs.uci.edu/QS](http://www.fs.uci.edu/QS)  
🌐 ZOT Account Online: <https://zotaccount.uci.edu/>

**CAMPUS BILLING**

Monday - Friday  
8:30 A.M. – 1:00 P.M. and 2:00 P.M. - 4:30 P.M.  
101 Aldrich Hall  
☎ Phone: (949) 824-2455  
☎ Fax: (949) 824-9807  
✉ E-mail: [cbs@uci.edu](mailto:cbs@uci.edu)  
🌐 Web: [www.fs.uci.edu/CBS/Cbs\\_home.htm](http://www.fs.uci.edu/CBS/Cbs_home.htm)



**CAMPUSWIDE HONORS PROGRAM OFFICE**

Monday – Friday  
8:00 A.M. – 5:00 P.M.  
1100 Student Services II  
☎ Phone: (949) 824-5461  
☎ Fax: (949) 824-2092  
✉ E-mail: [honors@uci.edu](mailto:honors@uci.edu)  
🌐 Web: [www.honors.uci.edu](http://www.honors.uci.edu)

**DISABILITY SERVICES CENTER**

Monday – Friday  
8:00 A.M. – 5:00 P.M.  
100 Disability Services Center, Bldg 313  
☎ Phone: (949) 824-7494  
☎ TDD: (949) 824-6272  
☎ Fax: (949) 824-3083  
✉ E-mail: [dsc@uci.edu](mailto:dsc@uci.edu)  
🌐 Web: [www.disability.uci.edu](http://www.disability.uci.edu)

**THE HILL (UCI BOOKSTORE)**

Monday – Thursday (8:00 A.M. – 7:00 P.M.)  
Friday (8:00 A.M. – 5:00 P.M.)  
Saturday (12:00 A.M. – 5:00 P.M.)  
Sunday (Closed)  
210-B Student Center  
☎ Phone: (949) 824-2665  
✉ E-mail: [books@uci.edu](mailto:books@uci.edu)  
🌐 Web: [www.book.uci.edu](http://www.book.uci.edu)

